



Secondary side mounting type Pulse blow unit PAUS Series

Specifications

Model		PAUS
Item		Air
Operating pressure range MPa [psi]		0.35 to 0.7 [51 to 102]
Pulse frequency	Hz	10 ±5(Supply air 0.5MPa[73psi]) <small>Note1</small>
Operating temperature range	°C [°F]	5 to 50 [41 to 122]
Material		Aluminum alloy
Mass	g [oz]	48 [1.7]
Port size	IN port	G1/8
	Out port	G1/8

Note 1: The frequency cannot be adjusted. This is the frequency of the pulse generated when 0.5 MPa [73 psi] is applied. For details, refer to Characteristics of the frequency and flow according to pressure.

2: Air that is used should be clean air that contains no oil, solids, or other contaminants. If drainage water, dust, and other contaminants get into the pulse blow unit, they could cause defective operation.

3: This product uses grease internally.

4: The flow rate guideline is 125 L/min by pulse blow, when 0.5 MPa [73 psi] is applied (with nozzle dia.φ4 mm).(Equivalent to 250 L/min continuous blow).

Order codes

● Main unit PAUS

Secondary side mounting
S:Secondary side mounting type



Dimensions (mm [in.])

● PAUS

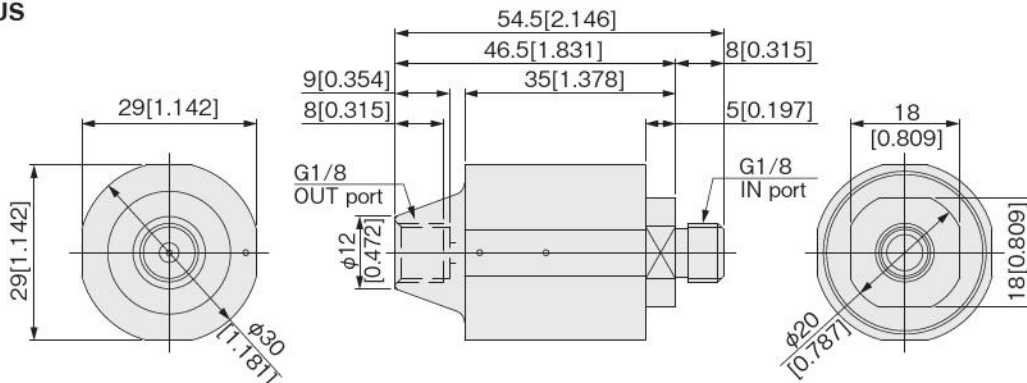

Applicable examples

- Mount the pulse blow unit between the air gun and the tip of the nozzle.

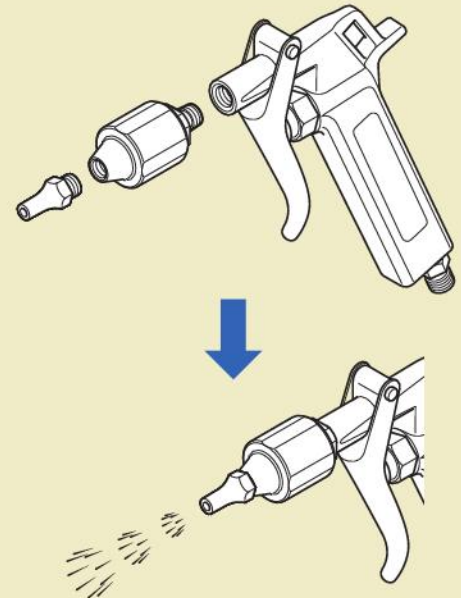

Characteristics of the frequency and flow according to pressure

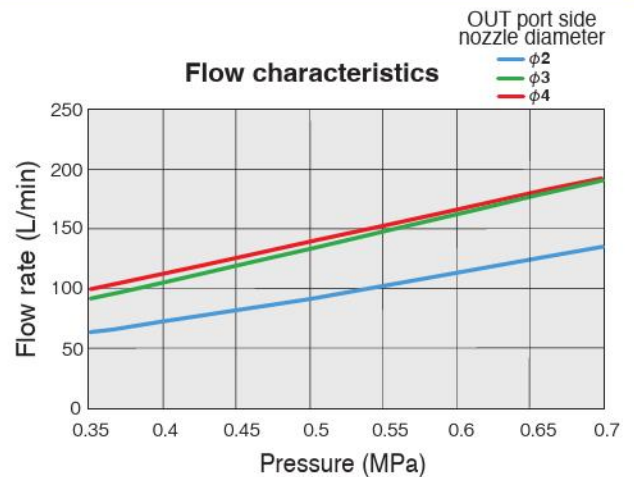
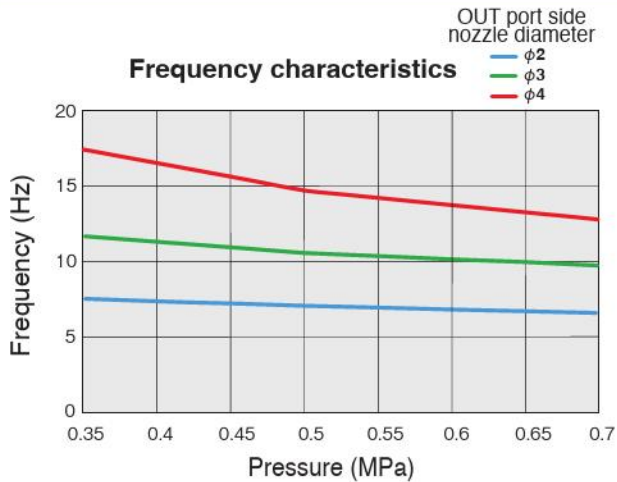

Note 1: According to our test conditions ①.

2: The characteristics of the frequency and the flow vary depending on the piping conditions and the nozzle used.

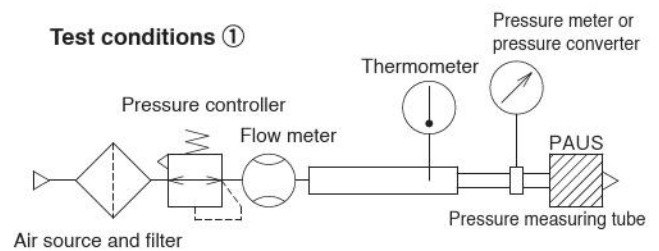

Operations according to piping conditions for pulse blow units

Operations may be unstable, depending on the piping conditions on the IN port side. See the following table.

Nozzle diameter	Operating pressure	Tube φ6 [0.236]			Tube φ8 [0.315]		
		1000 mm [39.370 in.]	3000mm [118.1 in.]	5000 mm [196.9 in.]	1000 mm [39.370 in.]	3000mm [118.1 in.]	5000 mm [196.9 in.]
φ2 [0.079]	0.35 MPa [51 psi]	○	○	○	○	○	○
	0.5 MPa [73 psi]	○	○	○	○	○	○
	0.7 MPa [102 psi]	○	○	○	○	○	○
φ3 [0.118]	0.35 MPa [51 psi]	○	○	○	○	○	○
	0.5 MPa [73 psi]	○	○	○	○	○	○
	0.7 MPa [102 psi]	○	○	○	○	○	○
φ4 [0.157]	0.35 MPa [51 psi]	×	×	×	○	×	×
	0.5 MPa [73 psi]	○	×	×	○	○	○
	0.7 MPa [102 psi]	○	○	○	○	○	○

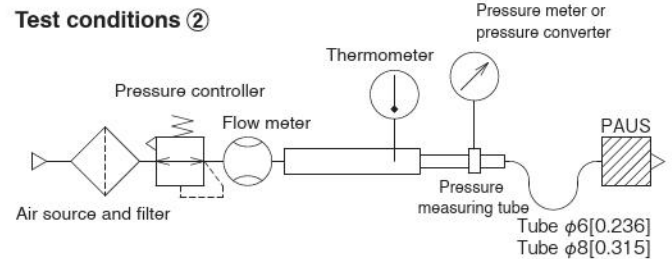

Note 1: ○ : Stable operations x: Unstable operations (according to our test conditions ②)

2: Operations will be unstable if the piping conditions cause pressure drops or insufficient flow.

Handling precautions

Warning

- Do not point the output port toward people.
- Wear protective eyewear and earplugs to prevent flying debris from entering your eyes and to prevent noise-induced hearing loss.
- Install a cutoff valve on the IN port side to ensure safety in case of leaks or damage.

Caution

- Air containing oil or solids cannot be used. Use cleaned air for the medium (use a filter that has a filtration rating of 40 μm or less). If drainage water, dust, and other contaminants get into this product, they could cause defective operation.
- Pass the medium through a device, such as a freeze-type air dryer or after cooler, to lower the dew-point temperature of the medium to below the ambient temperature so condensation or frost does not occur when the products are blowing.
- This product operates on a balance of pressure, so supply enough pressure and volume to keep the pulse operation steady.
- It is recommended to make a one-to-one connection between this product and an air blow gun or a nozzle.
- We recommend installing this product directly onto an air blow gun and nozzle.

Caution * Read "Safety precautions" on the general catalog website before using this product.

- When piping to the IN port, hold the width across flat on the IN port side with a spanner or similar tool, and when piping to the OUT port, hold the width across flat on the OUT port side with a spanner or similar tool, and tighten within the recommended tightening torque range below.

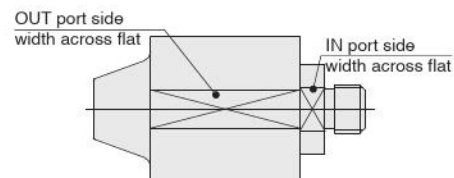

Recommended tightening torque	PAUS
N·m [in·lbf]	4.5 to 6.5 [39.83 to 57.53]

- Do not mount this product on the secondary side of an electrostatic eliminator. Doing so will reduce the neutralization function of air blowing considerably.
- Do not leave the product in dusty or scattered areas, as dust may enter the interior and cause malfunction.
- Do not drop, step on, or bump the product, as this may cause damage.
- Use tubing with an exterior that is not damaged. Do not allow tubing to become severely bent or twisted. Doing so may cause air leakage.