

Robot Joint

YASKAWA Robot Compatible

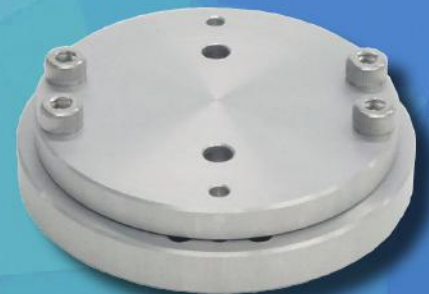

- Light weight and compact
- New designs not required
- Quickly connect 5 types of actuators
 - Flat type air hand
 - Compliance light
 - 3-finger hand
 - Auto hand changer
 - Electric hand

Robot Joint

YASKAWA Robot Compatible

- Specialized connectors (robot joints) are available for mounting 5 series of Koganei actuators to YASKAWA SCARA robots and vertically articulated robots.
- Man-hours can be greatly reduced from equipment setup by mounting robot joints to YASKAWA robots.

● YASKAWA Robots

YASKAWA



MOTOMAN SG400 Series



MOTOMAN GP7 Series



MOTOMAN GP12 Series

● Electric hand mounting example



● Flat type air hand mounting example



● 3 finger hand mounting example



<SCARA robot system example>

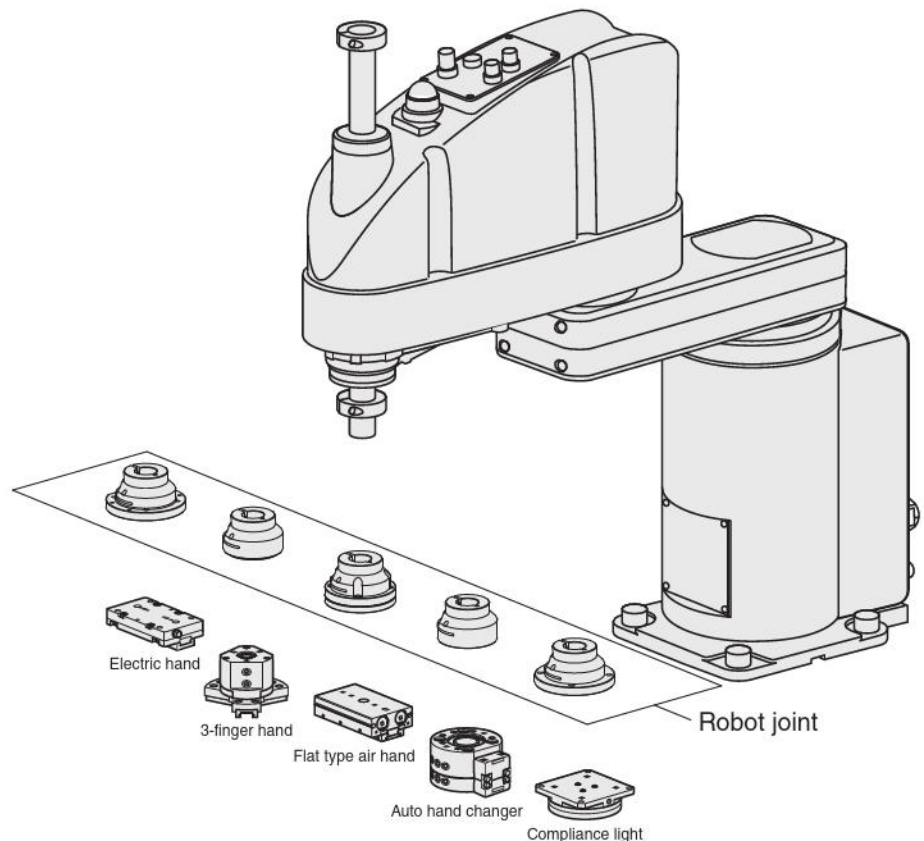

Order codes

● Robot joint models (for SCARA robots)

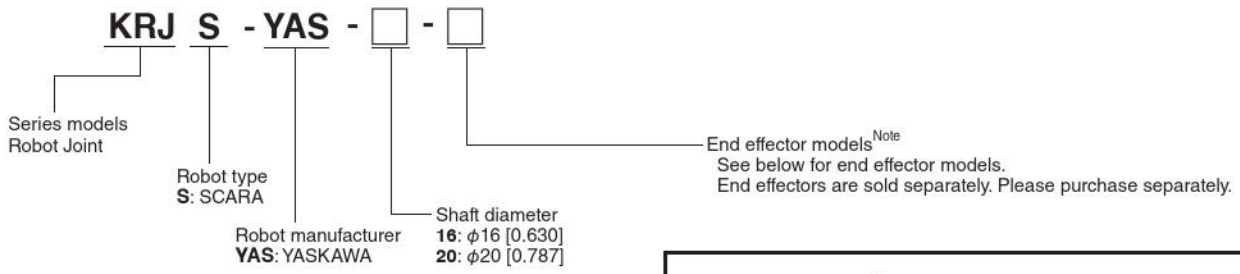

Note: See page ⑤ for combinations of shaft diameters and end effector models.

● Compatibility table for shaft diameters and YASKAWA robot models

Shaft diameter (mm [in.])	Robot model
16 [0.630]	MOTOMAN-SG400
20 [0.787]	MOTOMAN-SG650

● End effector models

Flat type air hand	3 finger hand	Electric hand		Compliance light	Auto hand changer
					
AFDPG6 AFDPG8 AFDPG12 AFDPG14 AFDPGL6 AFDPGL8 AFDPGL12 AFDPGL14	NHE1D16 NHE1D20 NHE1D25	EWHA6H EWHA12H EWHA24H EWHA36H EWHA12A EWHA24A EWHA36A	EW2H8 EW2H18 EW2H28 EW2HL8 EW2HL18 EW2HL28	CPL34F CPL54F CPL70F	MJC3 MJC10

Note: The above end effectors (5 series) are sold separately. Please purchase separately.

● Robot joint models (for vertically articulated robots)

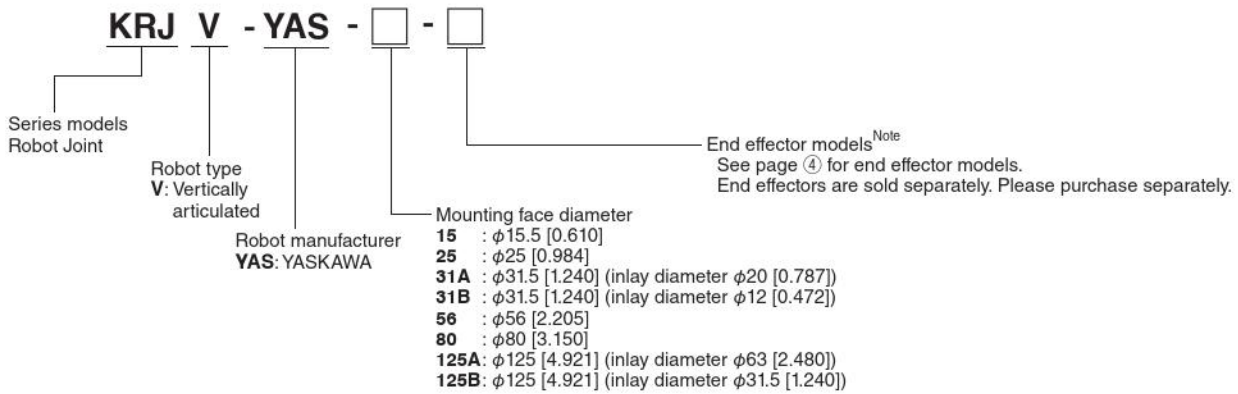







Note: See page 6 for combinations of mounting face diameters and end effector models.

● Compatibility table for mounting face diameters and YASKAWA robot models

Mounting face diameter (mm [in.])	Robot model
15 [0.591]	MotoMINI
25 [0.984]	MOTOMAN-MHJ
31 [1.220]A	MOTOMAN-MH3F
	MOTOMAN-MH3BM
	MOTOMAN-MPP3S(H)
31 [1.220]B	MOTOMAN-GP7
	MOTOMAN-GP8
	MOTOMAN-AR700
	MOTOMAN-AR900
56 [2.205]	MOTOMAN-GP12
	MOTOMAN-GP25
	MOTOMAN-AR1440(E)
	MOTOMAN-AR1730
	MOTOMAN-AR2010
80 [3.150]	MOTOMAN-GP35L
	MOTOMAN-GP50
	MOTOMAN-GP88
	MOTOMAN-MC2000II
	MOTOMAN-MCL50
	MOTOMAN-SP80
	MOTOMAN-MPL80II

Mounting face diameter (mm [in.])	Robot model
125 [4.921]A	MOTOMAN-MPL100II
	MOTOMAN-MPL160II
	MOTOMAN-MPL300II
	MOTOMAN-GP180(-120)
	MOTOMAN-GP215
	MOTOMAN-GP225
	MOTOMAN-GP250
	MOTOMAN-GP280
	MOTOMAN-GP165R
	MOTOMAN-GP200R
	MOTOMAN-SP165(-105)
	MOTOMAN-SP210
	MOTOMAN-SP235
	MOTOMAN-SP150R
MOTOMAN-SP185R	
MOTOMAN-MCL130	
MOTOMAN-MCL165(-100)	
125 [4.921]B	MOTOMAN-GP110
	MOTOMAN-SP100(B)

● End effector models

Flat type air hand	3 finger hand	Electric hand		Compliance light	Auto hand changer
					
AFDPG6	NHE1D16	EWHA6H	EW2H8	CPL34F	MJC3
AFDPG8	NHE1D20	EWHA12H	EW2H18	CPL54F	MJC10
AFDPG12	NHE1D25	EWHA24H	EW2H28	CPL70F	MJC20
AFDPG14		EWHA36H	EW2HL8	CPL90F	MJC60
AFDPG18		EWHA12A	EW2HL18		MJC100
AFDPG25		EWHA24A	EW2HL28		MJC150
AFDPGL6		EWHA36A			
AFDPGL8					
AFDPGL12					
AFDPGL14					
AFDPGL18					
AFDPGL25					

Note: The above end effectors (5 series) are sold separately. Please purchase separately.

Combination of shaft diameter and end effector models

SCARA Robots

● Air hand (flat type air hand and 3-finger hand) combinations

Shaft diameter	Flat type air hand								3 finger hand		
	AFDPG6	AFDPG8	AFDPG12	AFDPG14	AFDPGL6	AFDPGL8	AFDPGL12	AFDPGL14	NHE1D16	NHE1D20	NHE1D26
16	○	○	○	—	○	○	○	—	○	○	—
20	—	○	○	○	—	○	○	○	—	○	○

● Compliance light combinations

Shaft diameter	Compliance light		
	CPL34F	CPL64F	CPL70F
16	○	○	—
20	—	○	○

● Auto hand changer combinations

Shaft diameter	Auto hand changer	
	MJC3	MJC10
16	○	○
20	—	○

● Electric hand combinations

Shaft diameter	Electric hand												
	EWHA6H	EWHA12H	EWHA24H	EWHA36H	EWHA12A	EWHA24A	EWHA36A	EW2H8	EW2H18	EW2H28	EW2HL8	EW2HL18	EW2HL28
16	○	○	—	—	○	○	○	○	○	—	○	○	—
20	—	○	○	○	○	○	○	—	○	○	—	○	○

Combination of shaft diameter and end effector models

Vertically articulated robots

● Air hand (flat type air hand) combinations

Mounting face diameter	Flat type air hand											
	AFDPG6	AFDPG8	AFDPG12	AFDPG14	AFDPG18	AFDPG26	AFDPGL6	AFDPGL8	AFDPGL12	AFDPGL14	AFDPGL18	AFDPGL26
15	○	—	—	—	—	—	○	—	—	—	—	—
25	—	○	○	—	—	—	—	○	○	—	—	—
31A	—	—	○	○	—	—	—	—	○	○	—	—
31B	—	—	○	○	—	—	—	—	○	○	—	—
56	—	—	—	—	○	○	—	—	—	—	○	○
80	—	—	—	—	—	—	—	—	—	—	—	—
125A	—	—	—	—	—	—	—	—	—	—	—	—
125B	—	—	—	—	—	—	—	—	—	—	—	—

● Air hand (3-finger hand) combinations

Mounting face diameter	3 finger hand		
	NHE1D16	NHE1D20	NHE1D26
15	○	—	—
25	○	○	—
31A	—	○	○
31B	—	○	○
56	—	—	○
80	—	—	—
125A	—	—	—
125B	—	—	—

● Compliance light combinations

Mounting face diameter	Compliance light			
	CPL34F	CPL64F	CPL70F	CPL90F
15	○	—	—	—
25	○	○	—	—
31A	—	○	○	—
31B	—	○	○	—
56	—	—	—	○
80	—	—	—	—
125A	—	—	—	—
125B	—	—	—	—

● Auto hand changer combinations

Mounting face diameter	Auto hand changer					
	MJC3	MJC10	MJC20	MJC60	MJC100	MJC160
15	○	—	—	—	—	—
25	○	○	—	—	—	—
31A	○	○	—	—	—	—
31B	○	○	—	—	—	—
56	—	—	○	—	—	—
80	—	—	—	○	○	—
125A	—	—	—	—	—	○
125B	—	—	—	—	—	○

● Electric hand combinations

Mounting face diameter	Electric hand												
	EWHA6H	EWHA12H	EWHA24H	EWHA36H	EWHA12A	EWHA24A	EWHA36A	EW2H8	EW2H18	EW2H28	EW2HL8	EW2HL18	EW2HL28
15	○	—	—	—	○	—	—	○	—	—	○	—	—
25	○	○	—	—	○	○	○	○	○	—	○	○	—
31A	—	○	○	○	○	○	○	○	○	—	○	○	—
31B	—	○	○	○	○	○	○	○	○	—	○	○	—
56	—	—	○	○	—	○	○	—	—	○	—	—	○
80	—	—	—	—	—	—	—	—	—	—	—	—	—
125A	—	—	—	—	—	—	—	—	—	—	—	—	—
125B	—	—	—	—	—	—	—	—	—	—	—	—	—

Installation procedure

1. For SCARA robots (model: KRJS-□)

- ① Install the end effector and adapter plate.
If not included, the adapter plate is not required.
- ② Install the adapter plate (or end effector if the model does not include an adapter plate) and robot joint.
- ③ Insert the robot joint into the shaft, until the end.
- ④ We recommend the following procedure if the D-cut in the shaft is used for positioning.
The screw used in the tapped hole for positioning must be prepared by the customer.
【Recommended procedure when using tapped hole for positioning】
(1) Temporarily screw in the positioning screw, and then decide the position of the robot joint.
(2) Temporarily tighten the shaft clamp bolt to secure the robot joint.
(3) Remove the temporarily screwed in positioning screw.
- ⑤ Tighten the shaft clamp bolts.
- ⑥ Alternately tighten the shaft clamp bolts 3 times or more to the specified tightening torque.

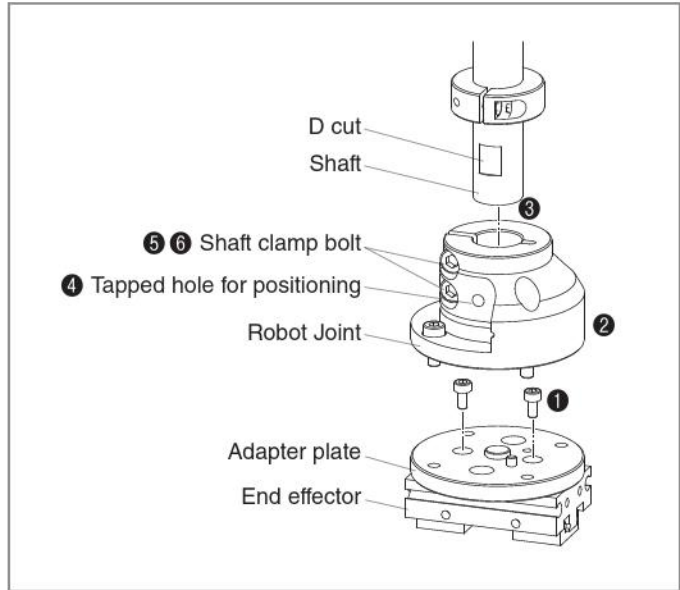

Caution

If you cannot insert the shaft because the shaft hole in the robot joint is too narrow, then put a plate (a washer or flathead screwdriver can also be used) into the slit, then tighten a bolt (a fastening screw is also possible) into the threaded hole, so the shaft hole widens and the shaft can be inserted. After insertion is complete, remove the bolt and plate.

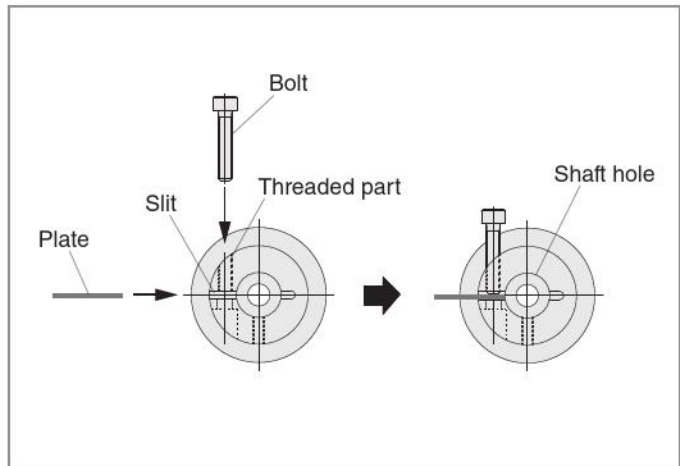

2. For vertically articulated robots (Model: KRJV-□)

- ① Install the end effector and adapter plate. If not included, the adapter plate is not required.
- ② Install the robot flange and robot joint.
- ③ Install the adapter plate (or end effector if the model does not include an adapter plate) and robot joint.

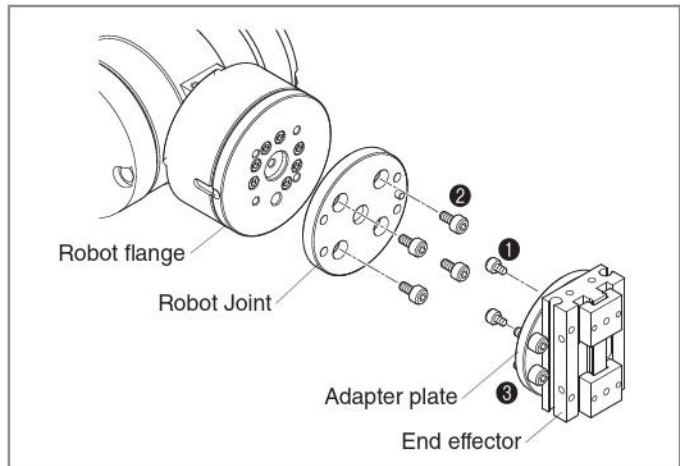

Handling instructions and precautions

Retaining force

● Robot Joint for SCARA robots

Shaft diameter (mm [in.])	Retaining force F(N [lbf])	Retaining torque T(N·m [in·lbf])	Allowable bending moment M(N·m [in·lbf])
16 I0.630I	1200 [269.8]	12 [106.2]	29 [256.7]
20 I0.787I	1300 [292.2]	13 [115.1]	29 [256.7]

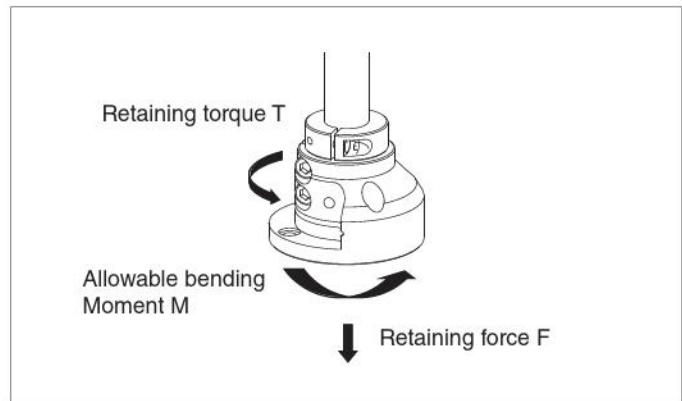

Material

Name of part	Material
Robot Joint	Aluminum alloy (alumite treatment)
Adapter plate	Aluminum alloy (alumite treatment)
Bolt	Stainless steel
Parallel pin	Stainless steel

Tightening torque

Screw size	Tightening torque (N·m [in·lbf])
M2.5	0.36 [3.186]
M3	0.63 [5.576]
M4	1.5 [13.277]
M5	3 [26.553]
M6	5.2 [46.025]
M8	12.5 [110.6]
M10	24.5 [216.8]

Caution

If there is a risk of bolts loosening due to shocks or vibrations, consider taking measures to prevent them from loosening.

Robot type: SCARA Shaft diameter: 16 [0.630]

● Air hand

Model	Mass (g)		Configuration	Shape	Dimensions								Accessories			
	Product ^{Note 2}	End effector ^{Note 3}			A	B	C	D	E	F	G	H	G		H	
													Size	pcs	Size	pcs
KRJS-YAS-16-AFDPG6	105	52	①	I	35	-	-	-	-	-	35	3	M2.5×12	2	B type 2×4	2
KRJS-YAS-16-AFDPG8	180	86	②	I	56	5	-	-	6	41	-	-	M3×6	2	B type 2.5×5	2
KRJS-YAS-16-AFDPG12	180	200	②	I	56	5	-	-	6	41	-	-	M4×8	2	B type 3×6	2
KRJS-YAS-16-AFDPGL6	130	60	①	II	56	6	38	-	-	-	-	-	M2.5×12	2	B type 2×4	2
KRJS-YAS-16-AFDPGL8	145	135	①	II	78	6	38	-	-	-	-	-	M3×14	2	B type 2.5×5	2
KRJS-YAS-16-AFDPGL12	175	330	①	II	96	8	41	-	-	-	-	-	M4×18	2	B type 3×6	2
KRJS-YAS-16-NHE1D16	120	170	①	I	41	10	-	-	-	-	-	-	M3×35	3	B type 2×4	1
KRJS-YAS-16-NHE1D20	135	306	①	I	48	10	-	-	-	-	-	-	M3×40	3	B type 3×6	1

● Compliance light

Model	Mass (g)		Configuration	Shape	Dimensions								Accessories			
	Product ^{Note 2}	End effector ^{Note 3}			A	B	C	D	E	F	G	H	G		H	
													Size	pcs	Size	pcs
KRJS-YAS-16-CPL34F	120	42	①	I	46	6	-	-	-	-	46	3	M3×8	4	B type 3×6	1
KRJS-YAS-16-CPL54F	135	130	①	I	54	6	-	-	-	-	-	-	M5×12	4	A type 4×6 ^{Note 4}	1

● Auto hand changer

Model	Mass (g)		Configuration	Shape	Dimensions								Accessories			
	Product ^{Note 2}	End effector ^{Note 3}			A	B	C	D	E	F	G	H	G		H	
													Size	pcs	Size	pcs
KRJS-YAS-16-MJC3	105	65	①	I	35	-	-	-	-	-	-	-	M3×20	4	B type 2×5	1
KRJS-YAS-16-MJC10	145	235	①	I	54	9	-	-	-	-	-	-	M5×30	4	B type 4×8	1

● Electric hand

Model	Mass (g)		Configuration	Shape	Dimensions								Accessories			
	Product ^{Note 2}	End effector ^{Note 3}			A	B	C	D	E	F	G	H	G		H	
													Size	pcs	Size	pcs
KRJS-YAS-16-EWHA6H	135	150	①	III	58	6	-	26	-	-	-	-	M3×10	4	B type 2×6	2
KRJS-YAS-16-EWHA12H	180	290	①	I	80	6	-	-	-	-	-	-	M3×16	4	B type 2×6	2
KRJS-YAS-16-EWHA12A	135	170	①	III	58	6	-	26	-	-	-	-	M3×12	4	B type 2×6	2
KRJS-YAS-16-EWHA24A	160	260	①	III	72	6	-	31	-	-	-	-	M3×12	4	B type 2×6	2
KRJS-YAS-16-EWHA36A	160	260	①	III	72	6	-	31	-	-	-	-	M3×12	4	B type 2×6	2
KRJS-YAS-16-EW2H8	135	90	①	III	58	6	-	26	-	-	-	-	M3×16	4	B type 2×6	2
KRJS-YAS-16-EW2H18	160	160	①	III	72	6	-	31	-	-	-	-	M4×18	4	B type 3×6	2
KRJS-YAS-16-EW2HL8	135	140	①	III	58	6	-	26	-	-	-	-	M3×16	4	B type 2×6	2
KRJS-YAS-16-EW2HL18	160	250	①	III	72	6	-	31	-	-	-	-	M4×18	4	B type 3×6	2

Note 1: In the drawings, the (★) bolts and pins are accessories.

2: The product weight includes the weight of the bolts and parallel pins that are accessories.

3: The end effectors are not included with these products. They must be ordered separately.

4: The KRJS-YAS-16-CPL54F uses the old JIS A type parallel pin for positioning the end effector.

Robot type: SCARA

Shaft diameter: 16 [0.630]

● Air hand

Model	Mass (g [oz])		Configuration	Shape	Dimensions								Accessories			
	Product ^{Note 2}	End effector ^{Note 3}			A	B	C	D	E	F	G	H	G		H	
													Size	pcs	Size	pcs
KRJS-YAS-16-AFDPG6	3.70	1.83	①	I	1.378	-	-	-	-	-	1.378	0.118	M2.5x12	2	B type 2x4	2
KRJS-YAS-16-AFDPG8	6.35	3.03	②	I	2.205	0.197	-	-	0.236	1.614	-	-	M3x6	2	B type 2.5x5	2
KRJS-YAS-16-AFDPG12	6.35	7.05	②	I	2.205	0.197	-	-	0.236	1.614	-	-	M4x8	2	B type 3x6	2
KRJS-YAS-16-AFDPGL6	4.59	2.12	①	II	2.205	0.236	1.496	-	-	-	-	-	M2.5x12	2	B type 2x4	2
KRJS-YAS-16-AFDPGL8	5.11	4.76	①	II	3.071	0.236	1.496	-	-	-	-	-	M3x14	2	B type 2.5x5	2
KRJS-YAS-16-AFDPGL12	6.17	11.64	①	II	3.780	0.315	1.614	-	-	-	-	-	M4x18	2	B type 3x6	2
KRJS-YAS-16-NHE1D16	4.23	6.00	①	I	1.614	0.394	-	-	-	-	-	-	M3x35	3	B type 2x4	1
KRJS-YAS-16-NHE1D20	4.76	10.79	①	I	1.890	0.394	-	-	-	-	-	-	M3x40	3	B type 3x6	1

● Compliance light

Model	Mass (g [oz])		Configuration	Shape	Dimensions								Accessories			
	Product ^{Note 2}	End effector ^{Note 3}			A	B	C	D	E	F	G	H	G		H	
													Size	pcs	Size	pcs
KRJS-YAS-16-CPL34F	4.23	1.48	①	I	1.811	0.236	-	-	-	-	1.811	0.118	M3x8	4	B type 3x6	1
KRJS-YAS-16-CPL54F	4.76	4.59	①	I	2.126	0.236	-	-	-	-	-	-	M5x12	4	A type 4x6 ^{Note 4}	1

● Auto hand changer

Model	Mass (g [oz])		Configuration	Shape	Dimensions								Accessories			
	Product ^{Note 2}	End effector ^{Note 3}			A	B	C	D	E	F	G	H	G		H	
													Size	pcs	Size	pcs
KRJS-YAS-16-MJC3	3.70	2.29	①	I	1.378	-	-	-	-	-	-	-	M3x20	4	B type 2x5	1
KRJS-YAS-16-MJC10	5.11	8.29	①	I	2.126	0.354	-	-	-	-	-	-	M5x30	4	B type 4x8	1

● Electric hand

Model	Mass (g [oz])		Configuration	Shape	Dimensions								Accessories			
	Product ^{Note 2}	End effector ^{Note 3}			A	B	C	D	E	F	G	H	G		H	
													Size	pcs	Size	pcs
KRJS-YAS-16-EWHA6H	4.76	5.29	①	III	2.283	0.236	-	1.024	-	-	-	-	M3x10	4	B type 2x6	2
KRJS-YAS-16-EWHA12H	6.35	10.23	①	I	3.150	0.236	-	-	-	-	-	-	M3x16	4	B type 2x6	2
KRJS-YAS-16-EWHA12A	4.76	6.00	①	III	2.283	0.236	-	1.024	-	-	-	-	M3x12	4	B type 2x6	2
KRJS-YAS-16-EWHA24A	5.64	9.17	①	III	2.835	0.236	-	1.220	-	-	-	-	M3x12	4	B type 2x6	2
KRJS-YAS-16-EWHA36A	5.64	9.17	①	III	2.835	0.236	-	1.220	-	-	-	-	M3x12	4	B type 2x6	2
KRJS-YAS-16-EW2H8	4.76	3.17	①	III	2.283	0.236	-	1.024	-	-	-	-	M3x16	4	B type 2x6	2
KRJS-YAS-16-EW2H18	5.64	5.64	①	III	2.835	0.236	-	1.220	-	-	-	-	M4x18	4	B type 3x6	2
KRJS-YAS-16-EW2HL8	4.76	4.94	①	III	2.283	0.236	-	1.024	-	-	-	-	M3x16	4	B type 2x6	2
KRJS-YAS-16-EW2HL18	5.64	8.82	①	III	2.835	0.236	-	1.220	-	-	-	-	M4x18	4	B type 3x6	2

Note 1: In the drawings, the (★) bolts and pins are accessories.

2: The product weight includes the weight of the bolts and parallel pins that are accessories.

3: The end effectors are not included with these products. They must be ordered separately.

4: The KRJS-YAS-16-CPL54F uses the old JIS A type parallel pin for positioning the end effector.

Robot type: SCARA
Shaft diameter: 20 [0.630]

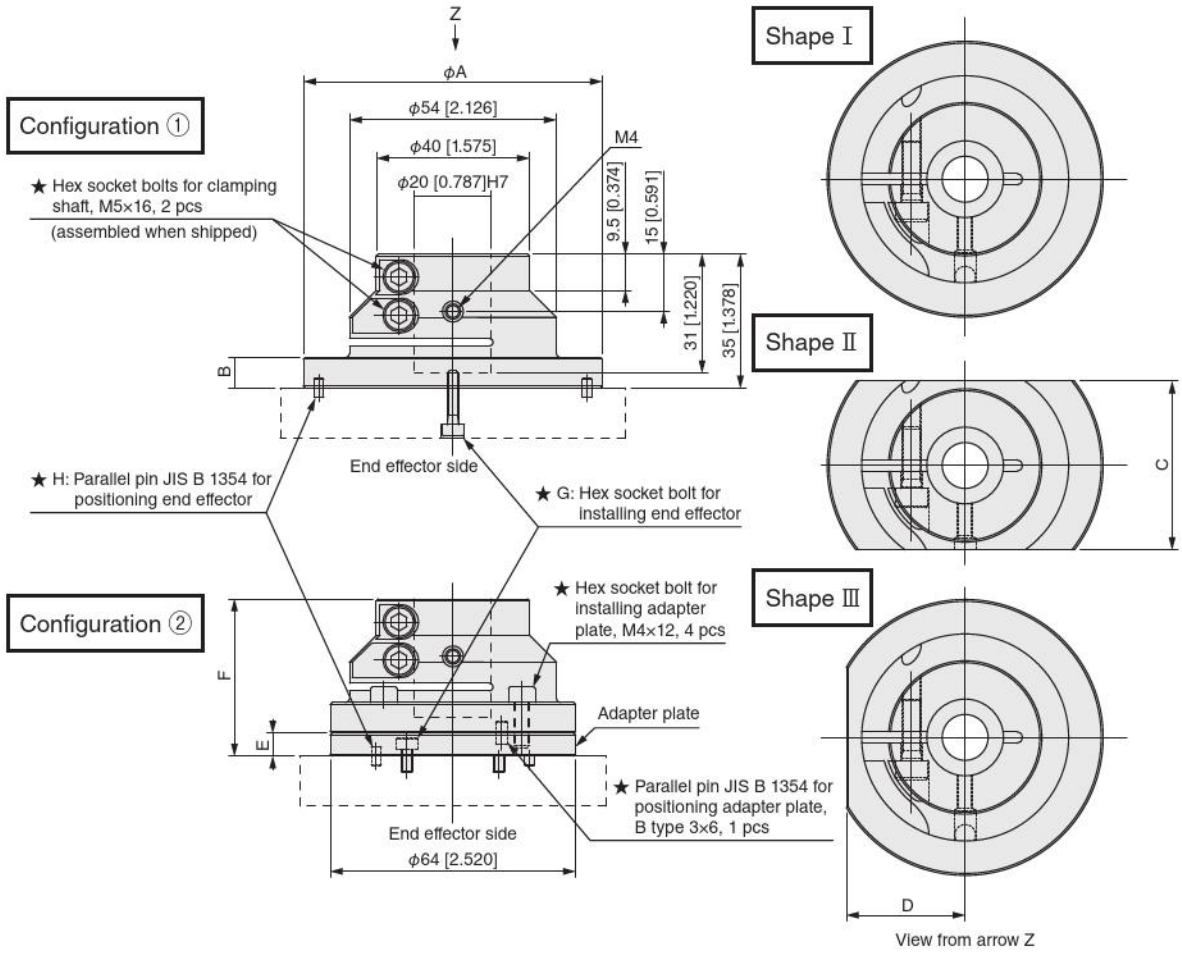

Robot type: SCARA

Shaft diameter: 20 [0.630]

● Air hand

Model	Mass (g)		Configuration	Shape	Dimensions						Accessories			
	Product ^{Note 2}	End effector ^{Note 3}			A	B	C	D	E	F	G		H	
											Size	pcs	Size	pcs
KRJS-YAS-20-AFDPG8	235	86	②	I	64	8	-	-	6	51	M3×6	2	B type 2.5×5	2
KRJS-YAS-20-AFDPG12	235	200	②	I	64	8	-	-	6	51	M4×8	2	B type 3×6	2
KRJS-YAS-20-AFDPG14	250	390	②	I	64	8	-	-	8	53	M5×10	2	B type 3×6	2
KRJS-YAS-20-AFDPGL8	170	135	①	II	78	8	44	-	-	-	M3×14	2	B type 2.5×5	2
KRJS-YAS-20-AFDPGL12	190	330	①	II	96	8	44	-	-	-	M4×18	2	B type 3×6	2
KRJS-YAS-20-AFDPGL14	170	570	①	II	90	8	44	-	-	-	M5×14	2	B type 3×6	2
KRJS-YAS-20-NHE1D20	140	306	①	I	48	10	-	-	-	-	M3×40	3	B type 3×6	1
KRJS-YAS-20-NHE1D25	170	580	①	I	60	10	-	-	-	-	M4×45	3	B type 3×6	1

● Compliance light

Model	Mass (g)		Configuration	Shape	Dimensions						Accessories			
	Product ^{Note 2}	End effector ^{Note 3}			A	B	C	D	E	F	G		H	
											Size	pcs	Size	pcs
KRJS-YAS-20-CPL54F	190	130	①	I	72	8	-	-	-	-	M5×10	4	B type 4×8	1
KRJS-YAS-20-CPL70F	190	250	①	I	70	8	-	-	-	-	M5×14	4	B type 5×8	1

● Auto hand changer

Model	Mass (g)		Configuration	Shape	Dimensions						Accessories			
	Product ^{Note 2}	End effector ^{Note 3}			A	B	C	D	E	F	G		H	
											Size	pcs	Size	pcs
KRJS-YAS-20-MJC10	150	235	①	I	54	9	-	-	-	-	M5×30	4	B type 4×8	1

● Electric hand

Model	Mass (g)		Configuration	Shape	Dimensions						Accessories			
	Product ^{Note 2}	End effector ^{Note 3}			A	B	C	D	E	F	G		H	
											Size	pcs	Size	pcs
KRJS-YAS-20-EWHA12H	215	290	①	I	80	8	-	-	-	-	M3×16	4	B type 2×6	2
KRJS-YAS-20-EWHA24H	215	350	①	I	80	8	-	-	-	-	M3×16	4	B type 2×6	2
KRJS-YAS-20-EWHA36H	215	360	①	I	80	8	-	-	-	-	M3×16	4	B type 2×6	2
KRJS-YAS-20-EWHA12A	155	170	①	I	58	8	-	-	-	-	M3×12	4	B type 2×6	2
KRJS-YAS-20-EWHA24A	190	260	①	III	72	8	-	31	-	-	M3×12	4	B type 2×6	2
KRJS-YAS-20-EWHA36A	190	260	①	III	72	8	-	31	-	-	M3×12	4	B type 2×6	2
KRJS-YAS-20-EW2H18	190	160	①	III	72	8	-	31	-	-	M4×18	4	B type 3×6	2
KRJS-YAS-20-EW2H28	240	360	①	III	88	8	-	40	-	-	M4×25	4	B type 3×6	2
KRJS-YAS-20-EW2HL18	190	250	①	III	72	8	-	31	-	-	M4×18	4	B type 3×6	2
KRJS-YAS-20-EW2HL28	240	480	①	III	88	8	-	40	-	-	M4×25	4	B type 3×6	2

Note 1: In the drawings, the (★) bolts and pins are accessories.

2: The product weight includes the weight of the bolts and parallel pins that are accessories.

3: The end effectors are not included with these products. They must be ordered separately.

Robot type: SCARA
Shaft diameter: 20 [0.630]

● Air hand

Model	Mass (g [oz])		Configuration	Shape	Dimensions						Accessories			
	Product ^{Note 2}	End effector ^{Note 3}			A	B	C	D	E	F	G		H	
											Size	pcs	Size	pcs
KRJS-YAS-20-AFDPG8	8.29	3.03	②	I	2.520	0.315	-	-	0.236	2.008	M3x6	2	B type 2.5x5	2
KRJS-YAS-20-AFDPG12	8.29	7.05	②	I	2.520	0.315	-	-	0.236	2.008	M4x8	2	B type 3x6	2
KRJS-YAS-20-AFDPG14	8.82	13.76	②	I	2.520	0.315	-	-	0.315	2.087	M5x10	2	B type 3x6	2
KRJS-YAS-20-AFDPGL8	6.00	4.76	①	II	3.071	0.315	1.732	-	-	-	M3x14	2	B type 2.5x5	2
KRJS-YAS-20-AFDPGL12	6.70	11.64	①	II	3.780	0.315	1.732	-	-	-	M4x18	2	B type 3x6	2
KRJS-YAS-20-AFDPGL14	6.00	20.11	①	II	3.543	0.315	1.732	-	-	-	M5x14	2	B type 3x6	2
KRJS-YAS-20-NHE1D20	4.94	10.79	①	I	1.890	0.394	-	-	-	-	M3x40	3	B type 3x6	1
KRJS-YAS-20-NHE1D25	6.00	20.46	①	I	2.362	0.394	-	-	-	-	M4x45	3	B type 3x6	1

● Compliance light

Model	Mass (g [oz])		Configuration	Shape	Dimensions						Accessories			
	Product ^{Note 2}	End effector ^{Note 3}			A	B	C	D	E	F	G		H	
											Size	pcs	Size	pcs
KRJS-YAS-20-CPL54F	6.70	4.59	①	I	2.835	0.315	-	-	-	-	M5x10	4	B type 4x8	1
KRJS-YAS-20-CPL70F	6.70	8.82	①	I	2.756	0.315	-	-	-	-	M5x14	4	B type 5x8	1

● Auto hand changer

Model	Mass (g [oz])		Configuration	Shape	Dimensions						Accessories			
	Product ^{Note 2}	End effector ^{Note 3}			A	B	C	D	E	F	G		H	
											Size	pcs	Size	pcs
KRJS-YAS-20-MJC10	5.29	8.29	①	I	2.126	0.354	-	-	-	-	M5x30	4	B type 4x8	1

● Electric hand

Model	Mass (g [oz])		Configuration	Shape	Dimensions						Accessories			
	Product ^{Note 2}	End effector ^{Note 3}			A	B	C	D	E	F	G		H	
											Size	pcs	Size	pcs
KRJS-YAS-20-EWHA12H	7.58	10.23	①	I	3.150	0.315	-	-	-	-	M3x16	4	B type 2x6	2
KRJS-YAS-20-EWHA24H	7.58	12.35	①	I	3.150	0.315	-	-	-	-	M3x16	4	B type 2x6	2
KRJS-YAS-20-EWHA36H	7.58	12.70	①	I	3.150	0.315	-	-	-	-	M3x16	4	B type 2x6	2
KRJS-YAS-20-EWHA12A	5.47	6.00	①	I	2.283	0.315	-	-	-	-	M3x12	4	B type 2x6	2
KRJS-YAS-20-EWHA24A	6.70	9.17	①	III	2.835	0.315	-	1.220	-	-	M3x12	4	B type 2x6	2
KRJS-YAS-20-EWHA36A	6.70	9.17	①	III	2.835	0.315	-	1.220	-	-	M3x12	4	B type 2x6	2
KRJS-YAS-20-EW2H18	6.70	5.64	①	III	2.835	0.315	-	1.220	-	-	M4x18	4	B type 3x6	2
KRJS-YAS-20-EW2H28	8.47	12.70	①	III	3.465	0.315	-	1.575	-	-	M4x25	4	B type 3x6	2
KRJS-YAS-20-EW2HL18	6.70	8.82	①	III	2.835	0.315	-	1.220	-	-	M4x18	4	B type 3x6	2
KRJS-YAS-20-EW2HL28	8.47	16.93	①	III	3.465	0.315	-	1.575	-	-	M4x25	4	B type 3x6	2

Note 1: In the drawings, the (★) bolts and pins are accessories.
 2: The product weight includes the weight of the bolts and parallel pins that are accessories.
 3: The end effectors are not included with these products. They must be ordered separately.

Robot type: Vertically articulated
Mounting face diameter: 15 [0.591]

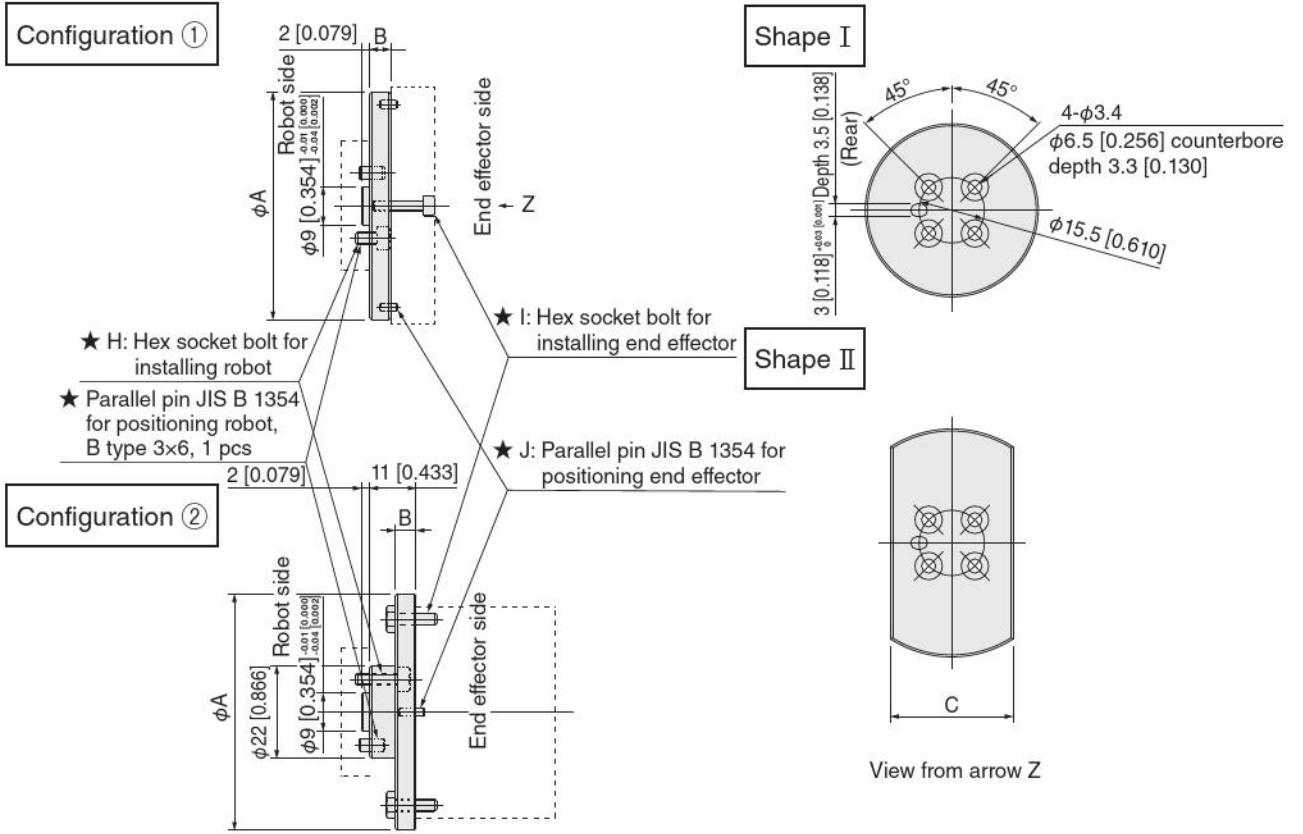

Robot type: Vertically articulated

Mounting face diameter: 15 [0.591]

● Air hand

Model	Mass (g)		Configuration	Shape	Dimensions			Accessories					
	Product ^{Note 2}	End effector ^{Note 3}			A	B	C	H		I		J	
								Size	pcs	Size	pcs	Size	pcs
KRJV-YAS-15-AFDPG6	15	52	①	I	29	5	-	M3×5	4	M2.5×12	2	B type 2×4	2
KRJV-YAS-15-AFDPGL6	25	60	①	II	54	5	29	M3×5	4	M2.5×12	2	B type 2×4	2
KRJV-YAS-15-NHE1D16	35	170	①	I	41	8	-	M3×5	4	M3×35	3	B type 2×4	1

● Compliance light

Model	Mass (g)		Configuration	Shape	Dimensions			Accessories					
	Product ^{Note 2}	End effector ^{Note 3}			A	B	C	H		I		J	
								Size	pcs	Size	pcs	Size	pcs
KRJV-YAS-15-CPL34F	30	42	①	I	46	5	-	M3×5	4	M3×8	4	B type 3×6	1

● Auto hand changer

Model	Mass (g)		Configuration	Shape	Dimensions			Accessories					
	Product ^{Note 2}	End effector ^{Note 3}			A	B	C	H		I		J	
								Size	pcs	Size	pcs	Size	pcs
KRJV-YAS-15-MJC3	15	65	①	I	34	5	-	M3×5	4	M3×20	4	B type 2×5	1

● Electric hand

Model	Mass (g)		Configuration	Shape	Dimensions			Accessories					
	Product ^{Note 2}	End effector ^{Note 3}			A	B	C	H		I		J	
								Size	pcs	Size	pcs	Size	pcs
KRJV-YAS-15-EWHA6H	50	150	②	I	56	5	-	M3×10	4	M3×10 ^{Note 4}	4	B type 2×6	2
KRJV-YAS-15-EWHA12A	45	170	①	I	58	5	-	M3×5	4	M3×10	4	B type 2×6	2
KRJV-YAS-15-EW2H8	45	90	①	I	58	5	-	M3×5	4	M3×16	4	B type 2×6	2
KRJV-YAS-15-EW2HL8	45	140	①	I	58	5	-	M3×5	4	M3×16	4	B type 2×6	2

Note 1: In the drawings, the (★) bolts and pins are accessories.

2: The product weight includes the weight of the bolts and parallel pins that are accessories.

3: The end effectors are not included with these products. They must be ordered separately.

4: KRJV-YAS-15-EWHA6H uses hex bolts for mounting the end effectors.

Robot type: Vertically articulated

Mounting face diameter: 15 [0.591]

● Air hand

Model	Mass (g [oz])		Configuration	Shape	Dimensions			Accessories					
	Product ^{Note 2}	End effector ^{Note 3}			A	B	C	H		I		J	
								Size	pcs	Size	pcs	Size	pcs
KRJV-YAS-15-AFDPG6	0.53	1.83	①	I	1.142	0.197	-	M3x5	4	M2.5x12	2	B type 2x4	2
KRJV-YAS-15-AFDPL6	0.88	2.12	①	II	2.126	0.197	1.142	M3x5	4	M2.5x12	2	B type 2x4	2
KRJV-YAS-15-NHE1D16	1.23	6.00	①	I	1.614	0.315	-	M3x5	4	M3x35	3	B type 2x4	1

● Compliance light

Model	Mass (g [oz])		Configuration	Shape	Dimensions			Accessories					
	Product ^{Note 2}	End effector ^{Note 3}			A	B	C	H		I		J	
								Size	pcs	Size	pcs	Size	pcs
KRJV-YAS-15-CPL34F	1.06	1.48	①	I	1.811	0.197	-	M3x5	4	M3x8	4	B type 3x6	1

● Auto hand changer

Model	Mass (g [oz])		Configuration	Shape	Dimensions			Accessories					
	Product ^{Note 2}	End effector ^{Note 3}			A	B	C	H		I		J	
								Size	pcs	Size	pcs	Size	pcs
KRJV-YAS-15-MJC3	0.53	2.29	①	I	1.339	0.197	-	M3x5	4	M3x20	4	B type 2x5	1

● Electric hand

Model	Mass (g [oz])		Configuration	Shape	Dimensions			Accessories					
	Product ^{Note 2}	End effector ^{Note 3}			A	B	C	H		I		J	
								Size	pcs	Size	pcs	Size	pcs
KRJV-YAS-15-EWHA6H	1.76	5.29	②	I	2.205	0.197	-	M3x10	4	M3x10 ^{Note 4}	4	B type 2x6	2
KRJV-YAS-15-EWHA12A	1.59	6.00	①	I	2.283	0.197	-	M3x5	4	M3x10	4	B type 2x6	2
KRJV-YAS-15-EW2H8	1.59	3.17	①	I	2.283	0.197	-	M3x5	4	M3x16	4	B type 2x6	2
KRJV-YAS-15-EW2HL8	1.59	4.94	①	I	2.283	0.197	-	M3x5	4	M3x16	4	B type 2x6	2

Note 1: In the drawings, the (★) bolts and pins are accessories.

2: The product weight includes the weight of the bolts and parallel pins that are accessories.

3: The end effectors are not included with these products. They must be ordered separately.

4: KRJV-YAS-15-EWHA6H uses hex bolts for mounting the end effectors.

Robot type: Vertically articulated
Mounting face diameter: 25 [0.984]

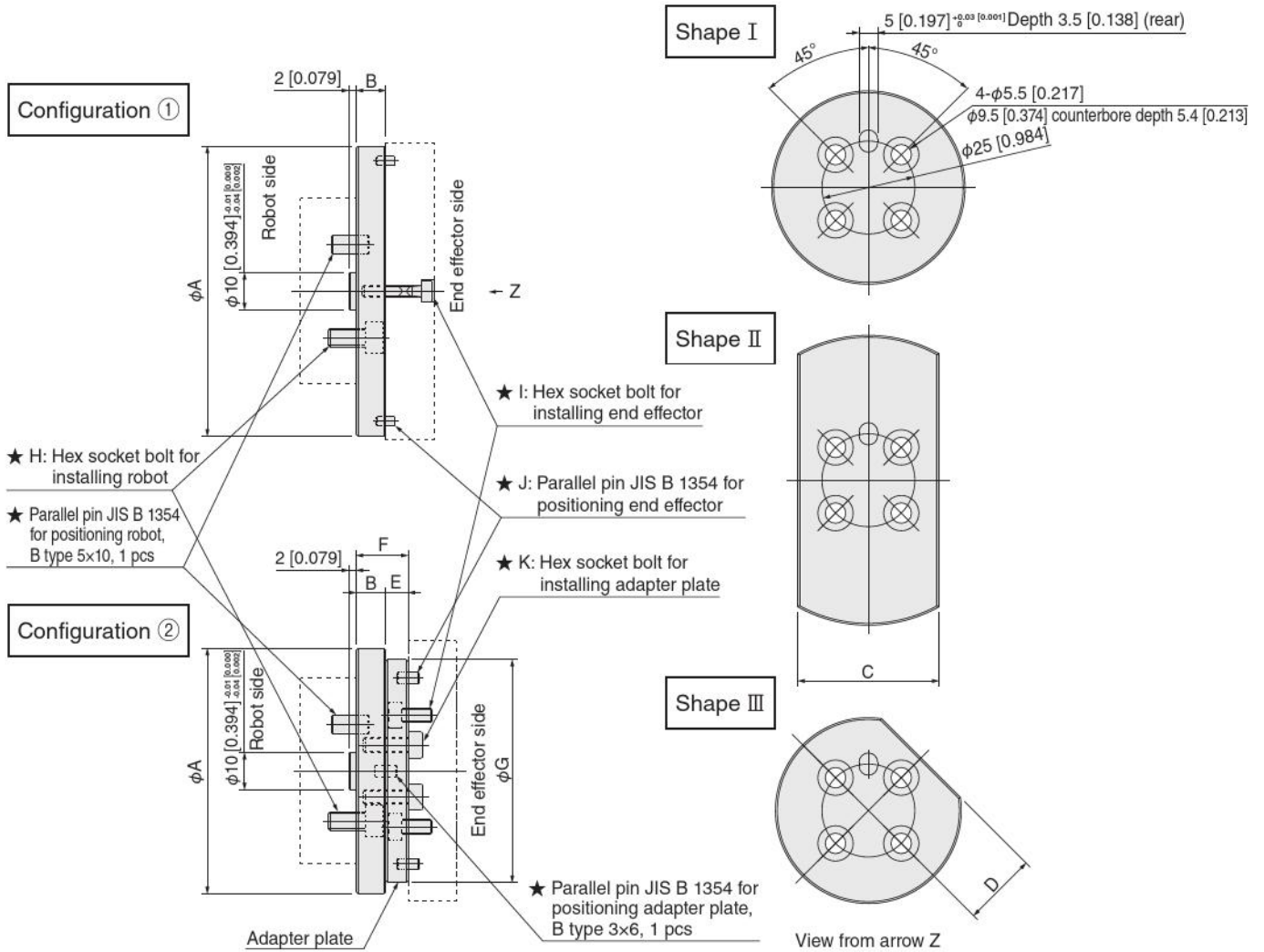

Robot type: Vertically articulated Mounting face diameter: 25 [0.984]

● Air hand

Model	Mass (g)		Configuration	Shape	Dimensions								Accessories							
	Product ^{Note 2}	End effector ^{Note 3}			A	B	C	D	E	F	G	H		I		J		K		
												Size	pcs	Size	pcs	Size	pcs	Size	pcs	
KRJV-YAS-25-AFDPG8	90	86	②	I	52	8	-	-	5	13	52	M5×10	4	M3×6	2	B type 2.5×5	2	M4×12	4	
KRJV-YAS-25-AFDPG12	125	200	②	I	60	8	-	-	6	14	60	M5×10	4	M4×8	2	B type 3×6	2	M4×12	4	
KRJV-YAS-25-AFDPGL8	75	135	①	II	78	8	36	-	-	-	-	M5×10	4	M3×16	2	B type 2.5×5	2	-	-	
KRJV-YAS-25-AFDPGL12	95	330	①	II	96	8	41	-	-	-	-	M5×10	4	M4×20	2	B type 3×6	2	-	-	
KRJV-YAS-25-NHE1D16	145	170	②	I	60	6	-	-	8	16	60	M5×10	4	M3×35	3	B type 2×4	1	M4×12	3	
KRJV-YAS-25-NHE1D20	50	306	①	I	48	8	-	-	-	-	-	M5×10	4	M3×40	3	B type 3×6	1	-	-	

● Compliance light

Model	Mass (g)		Configuration	Shape	Dimensions								Accessories							
	Product ^{Note 2}	End effector ^{Note 3}			A	B	C	D	E	F	G	H		I		J		K		
												Size	pcs	Size	pcs	Size	pcs	Size	pcs	
KRJV-YAS-25-CPL34F	45	42	①	I	46	6	-	-	-	-	-	M5×10	4	M3×8	4	B type 3×6	1	-	-	
KRJV-YAS-25-CPL54F	105	130	①	I	72	8	-	-	-	-	-	M5×10	4	M5×12	4	B type 4×8	1	-	-	

● Auto hand changer

Model	Mass (g)		Configuration	Shape	Dimensions								Accessories							
	Product ^{Note 2}	End effector ^{Note 3}			A	B	C	D	E	F	G	H		I		J		K		
												Size	pcs	Size	pcs	Size	pcs	Size	pcs	
KRJV-YAS-25-MJC3	60	65	①	III	50	10	-	20	-	-	-	M5×12	4	M3×20	4	B type 2×5	1	-	-	
KRJV-YAS-25-MJC10	75	235	①	I	54	10	-	-	-	-	-	M5×12	4	M5×30	4	B type 4×8	1	-	-	

● Electric hand

Model	Mass (g)		Configuration	Shape	Dimensions								Accessories							
	Product ^{Note 2}	End effector ^{Note 3}			A	B	C	D	E	F	G	H		I		J		K		
												Size	pcs	Size	pcs	Size	pcs	Size	pcs	
KRJV-YAS-25-EWHA6H	90	150	② ^{Note 4}	I	40	13	-	-	5	18	56	M5×20	4	M3×10 ^{Note 5}	4	B type 2×6	2	-	-	
KRJV-YAS-25-EWHA12H	125	290	①	I	80	8	-	-	-	-	-	M5×10	4	M3×16	4	B type 2×6	2	-	-	
KRJV-YAS-25-EWHA12A	70	170	①	I	58	8	-	-	-	-	-	M5×10	4	M3×12	4	B type 2×6	2	-	-	
KRJV-YAS-25-EWHA24A	105	260	①	I	72	8	-	-	-	-	-	M5×10	4	M3×12	4	B type 2×6	2	-	-	
KRJV-YAS-25-EWHA36A	105	260	①	I	72	8	-	-	-	-	-	M5×10	4	M3×12	4	B type 2×6	2	-	-	
KRJV-YAS-25-EW2H8	70	90	①	I	58	8	-	-	-	-	-	M5×10	4	M3×18	4	B type 2×6	2	-	-	
KRJV-YAS-25-EW2H18	105	160	①	I	72	8	-	-	-	-	-	M5×10	4	M4×18	4	B type 3×6	2	-	-	
KRJV-YAS-25-EW2HL8	70	140	①	I	58	8	-	-	-	-	-	M5×10	4	M3×18	4	B type 2×6	2	-	-	
KRJV-YAS-25-EW2HL18	105	250	①	I	72	8	-	-	-	-	-	M5×10	4	M4×18	4	B type 3×6	2	-	-	

Note 1: In the drawings, the (★) bolts and pins are accessories.

2: The product weight includes the weight of the bolts and parallel pins that are accessories.

3: The end effectors are not included with these products. They must be ordered separately.

4: KRJV-YAS-25-EWHA6H has an integrated robot joint and adapter plate.

5: KRJV-YAS-25-EWHA6H uses hex bolts for mounting the end effectors.

Robot type: Vertically articulated Mounting face diameter: 25 [0.984]

● Air hand

Model	Mass (g [oz])		Configuration	Shape	Dimensions							Accessories							
	Product ^{Note 2}	End effector ^{Note 3}			A	B	C	D	E	F	G	H		I		J		K	
												Size	pcs	Size	pcs	Size	pcs	Size	pcs
KRJV-YAS-25-AFDPG8	3.17	3.03	②	I	2.047	0.315	-	-	0.197	0.512	2.047	M5×10	4	M3×6	2	B type 2.5×5	2	M4×12	4
KRJV-YAS-25-AFDPG12	4.41	7.05	②	I	2.362	0.315	-	-	0.236	0.551	2.362	M5×10	4	M4×8	2	B type 3×6	2	M4×12	4
KRJV-YAS-25-AFDPGL8	2.65	4.76	①	II	3.071	0.315	1.417	-	-	-	-	M5×10	4	M3×16	2	B type 2.5×5	2	-	-
KRJV-YAS-25-AFDPGL12	3.35	11.64	①	II	3.780	0.315	1.614	-	-	-	-	M5×10	4	M4×20	2	B type 3×6	2	-	-
KRJV-YAS-25-NHE1D16	5.11	6.00	②	I	2.362	0.236	-	-	0.315	0.630	2.362	M5×10	4	M3×35	3	B type 2×4	1	M4×12	3
KRJV-YAS-25-NHE1D20	1.76	10.79	①	I	1.890	0.315	-	-	-	-	-	M5×10	4	M3×40	3	B type 3×6	1	-	-

● Compliance light

Model	Mass (g [oz])		Configuration	Shape	Dimensions							Accessories							
	Product ^{Note 2}	End effector ^{Note 3}			A	B	C	D	E	F	G	H		I		J		K	
												Size	pcs	Size	pcs	Size	pcs	Size	pcs
KRJV-YAS-25-CPL34F	1.59	1.48	①	I	1.811	0.236	-	-	-	-	-	M5×10	4	M3×8	4	B type 3×6	1	-	-
KRJV-YAS-25-CPL54F	3.70	4.59	①	I	2.835	0.315	-	-	-	-	-	M5×10	4	M5×12	4	B type 4×8	1	-	-

● Auto hand changer

Model	Mass (g [oz])		Configuration	Shape	Dimensions							Accessories							
	Product ^{Note 2}	End effector ^{Note 3}			A	B	C	D	E	F	G	H		I		J		K	
												Size	pcs	Size	pcs	Size	pcs	Size	pcs
KRJV-YAS-25-MJC3	2.12	2.29	①	III	1.969	0.394	-	0.787	-	-	-	M5×12	4	M3×20	4	B type 2×5	1	-	-
KRJV-YAS-25-MJC10	2.65	8.29	①	I	2.126	0.394	-	-	-	-	-	M5×12	4	M5×30	4	B type 4×8	1	-	-

● Electric hand

Model	Mass (g [oz])		Configuration	Shape	Dimensions							Accessories							
	Product ^{Note 2}	End effector ^{Note 3}			A	B	C	D	E	F	G	H		I		J		K	
												Size	pcs	Size	pcs	Size	pcs	Size	pcs
KRJV-YAS-25-EWHA6H	3.17	5.29	② ^{Note 4}	I	1.575	0.512	-	-	0.197	0.709	2.205	M5×20	4	M3×10 ^{Note 5}	4	B type 2×6	2	-	-
KRJV-YAS-25-EWHA12H	4.41	10.23	①	I	3.150	0.315	-	-	-	-	-	M5×10	4	M3×16	4	B type 2×6	2	-	-
KRJV-YAS-25-EWHA12A	2.47	6.00	①	I	2.283	0.315	-	-	-	-	-	M5×10	4	M3×12	4	B type 2×6	2	-	-
KRJV-YAS-25-EWHA24A	3.70	9.17	①	I	2.835	0.315	-	-	-	-	-	M5×10	4	M3×12	4	B type 2×6	2	-	-
KRJV-YAS-25-EWHA36A	3.70	9.17	①	I	2.835	0.315	-	-	-	-	-	M5×10	4	M3×12	4	B type 2×6	2	-	-
KRJV-YAS-25-EW2H8	2.47	3.17	①	I	2.283	0.315	-	-	-	-	-	M5×10	4	M3×18	4	B type 2×6	2	-	-
KRJV-YAS-25-EW2H18	3.70	5.64	①	I	2.835	0.315	-	-	-	-	-	M5×10	4	M4×18	4	B type 3×6	2	-	-
KRJV-YAS-25-EW2HL8	2.47	4.94	①	I	2.283	0.315	-	-	-	-	-	M5×10	4	M3×18	4	B type 2×6	2	-	-
KRJV-YAS-25-EW2HL18	3.70	8.82	①	I	2.835	0.315	-	-	-	-	-	M5×10	4	M4×18	4	B type 3×6	2	-	-

Note 1: In the drawings, the (★) bolts and pins are accessories.

2: The product weight includes the weight of the bolts and parallel pins that are accessories.

3: The end effectors are not included with these products. They must be ordered separately.

4: KRJV-YAS-25-EWHA6H has an integrated robot joint and adapter plate.

5: KRJV-YAS-25-EWHA6H uses hex bolts for mounting the end effectors.

Robot type: Vertically articulated
Mounting face diameter: 31 [1.220]A

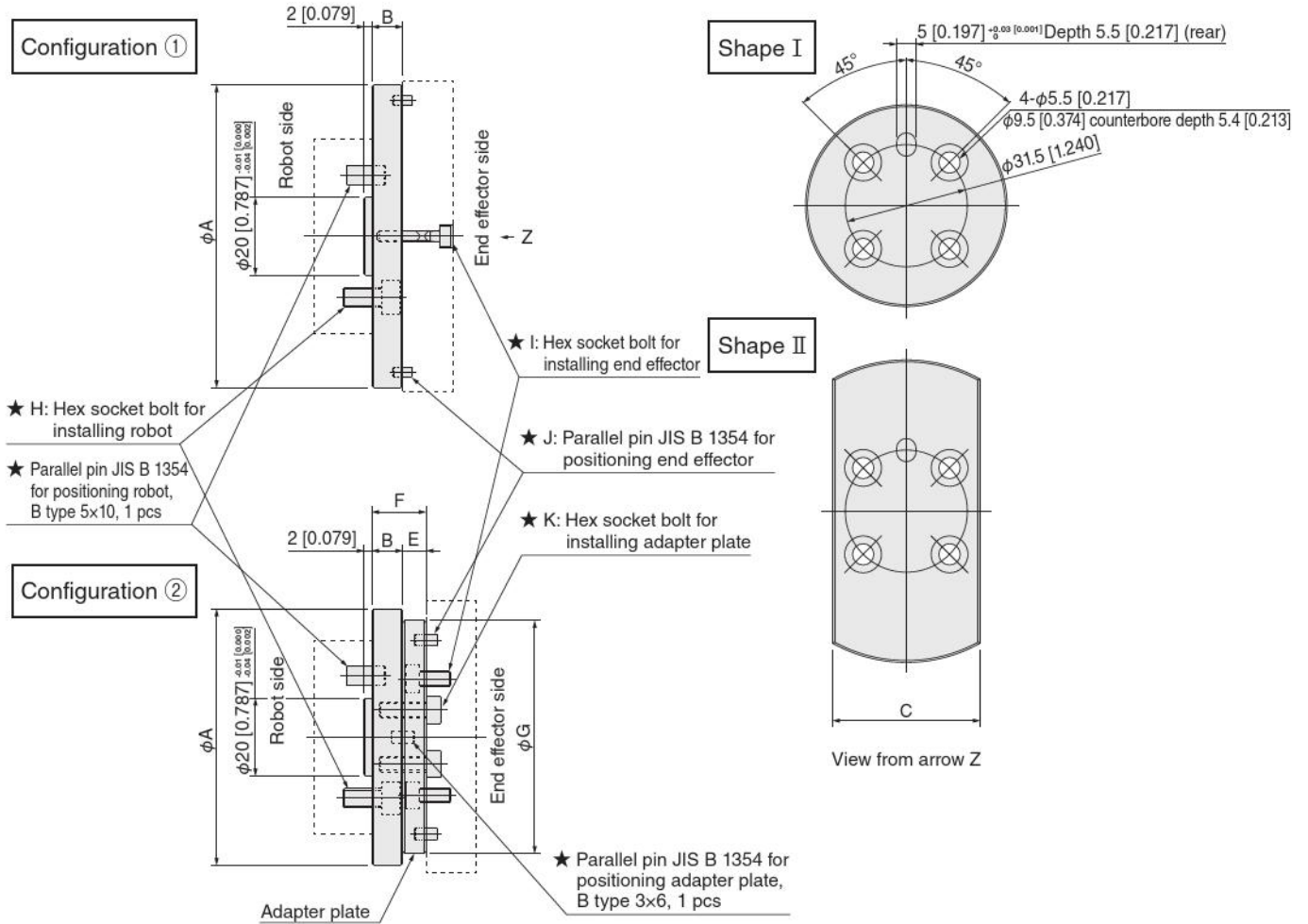

Robot type: Vertically articulated Mounting face diameter: 31 [1.220]A

● Air hand

Model	Mass (g)		Configuration	Shape	Dimensions								Accessories							
	Product ^{Note 2}	End effector ^{Note 3}			A	B	C	D	E	F	G	H		I		J		K		
												Size	pcs	Size	pcs	Size	pcs	Size	pcs	
KRJV-YAS-31A-AFDPG12	140	200	②	I	66	8	-	-	6	14	60	M5×10	4	M4×8	2	B type 3×6	2	M4×12	4	
KRJV-YAS-31A-AFDPG14	170	390	②	I	66	8	-	-	8	16	66	M5×10	4	M5×10	2	B type 3×6	2	M4×14	4	
KRJV-YAS-31A-AFDPGL12	95	330	①	II	96	8	41	-	-	-	-	M5×10	4	M4×20	2	B type 3×6	2	-	-	
KRJV-YAS-31A-AFDPGL14	225	570	②	II	66	8	66	-	8	16	92	M5×10	4	M5×14	2	B type 3×6	2	M4×14	4	
KRJV-YAS-31A-NHE1D20	50	306	①	I	52	8	-	-	-	-	-	M5×10	4	M3×40	3	B type 3×6	1	-	-	
KRJV-YAS-31A-NHE1D25	75	580	①	I	60	8	-	-	-	-	-	M5×10	4	M4×45	3	B type 3×6	1	-	-	

● Compliance light

Model	Mass (g)		Configuration	Shape	Dimensions								Accessories							
	Product ^{Note 2}	End effector ^{Note 3}			A	B	C	D	E	F	G	H		I		J		K		
												Size	pcs	Size	pcs	Size	pcs	Size	pcs	
KRJV-YAS-31A-CPL54F	105	130	①	I	72	8	-	-	-	-	-	M5×10	4	M5×12	4	B type 4×8	1	-	-	
KRJV-YAS-31A-CPL70F	175	250	①	I	92	8	-	-	-	-	-	M5×10	4	M5×12	4	B type 5×8	1	-	-	

● Auto hand changer

Model	Mass (g)		Configuration	Shape	Dimensions								Accessories							
	Product ^{Note 2}	End effector ^{Note 3}			A	B	C	D	E	F	G	H		I		J		K		
												Size	pcs	Size	pcs	Size	pcs	Size	pcs	
KRJV-YAS-31A-MJC3	40	65	①	I	42	8	-	-	-	-	-	M5×10	4	M3×20	4	B type 2×5	1	-	-	
KRJV-YAS-31A-MJC10	75	235	①	I	54	10	-	-	-	-	-	M5×12	4	M5×30	4	B type 4×8	1	-	-	

● Electric hand

Model	Mass (g)		Configuration	Shape	Dimensions								Accessories							
	Product ^{Note 2}	End effector ^{Note 3}			A	B	C	D	E	F	G	H		I		J		K		
												Size	pcs	Size	pcs	Size	pcs	Size	pcs	
KRJV-YAS-31A-EWHA12H	130	290	①	I	80	8	-	-	-	-	-	M5×10	4	M3×16	4	B type 2×6	2	-	-	
KRJV-YAS-31A-EWHA24H	130	350	①	I	80	8	-	-	-	-	-	M5×10	4	M3×16	4	B type 2×6	2	-	-	
KRJV-YAS-31A-EWHA36H	130	360	①	I	80	8	-	-	-	-	-	M5×10	4	M3×16	4	B type 2×6	2	-	-	
KRJV-YAS-31A-EWHA12A	70	170	①	I	58	8	-	-	-	-	-	M5×10	4	M3×12	4	B type 2×6	2	-	-	
KRJV-YAS-31A-EWHA24A	105	260	①	I	72	8	-	-	-	-	-	M5×10	4	M3×12	4	B type 2×6	2	-	-	
KRJV-YAS-31A-EWHA36A	105	260	①	I	72	8	-	-	-	-	-	M5×10	4	M3×12	4	B type 2×6	2	-	-	
KRJV-YAS-31A-EW2H8	70	90	①	I	58	8	-	-	-	-	-	M5×10	4	M3×18	4	B type 2×6	2	-	-	
KRJV-YAS-31A-EW2H18	105	160	①	I	72	8	-	-	-	-	-	M5×10	4	M4×18	4	B type 3×6	2	-	-	
KRJV-YAS-31A-EW2HL8	70	140	①	I	58	8	-	-	-	-	-	M5×10	4	M3×18	4	B type 2×6	2	-	-	
KRJV-YAS-31A-EW2HL18	105	250	①	I	72	8	-	-	-	-	-	M5×10	4	M4×18	4	B type 3×6	2	-	-	

Note 1: In the drawings, the (★) bolts and pins are accessories.

2: The product weight includes the weight of the bolts and parallel pins that are accessories.

3: The end effectors are not included with these products. They must be ordered separately.

Robot type: Vertically articulated Mounting face diameter: 31 [1.220]A

● Air hand

Model	Mass (g [oz])		Configuration	Shape	Dimensions							Accessories							
	Product ^{Note 2}	End effector ^{Note 3}			A	B	C	D	E	F	G	H		I		J		K	
												Size	pcs	Size	pcs	Size	pcs	Size	pcs
KRJV-YAS-31A-AFDPG12	4.94	7.05	②	I	2.598	0.315	-	-	0.236	0.551	2.362	M5×10	4	M4×8	2	B type 3×6	2	M4×12	4
KRJV-YAS-31A-AFDPG14	6.00	13.76	②	I	2.598	0.315	-	-	0.315	0.630	2.598	M5×10	4	M5×10	2	B type 3×6	2	M4×14	4
KRJV-YAS-31A-AFDPGL12	3.35	11.64	①	II	3.780	0.315	1.614	-	-	-	-	M5×10	4	M4×20	2	B type 3×6	2	-	-
KRJV-YAS-31A-AFDPGL14	7.94	20.11	②	II	2.598	0.315	2.598	-	0.315	0.630	3.622	M5×10	4	M5×14	2	B type 3×6	2	M4×14	4
KRJV-YAS-31A-NHE1D20	1.76	10.79	①	I	2.047	0.315	-	-	-	-	-	M5×10	4	M3×40	3	B type 3×6	1	-	-
KRJV-YAS-31A-NHE1D25	2.65	20.46	①	I	2.362	0.315	-	-	-	-	-	M5×10	4	M4×45	3	B type 3×6	1	-	-

● Compliance light

Model	Mass (g [oz])		Configuration	Shape	Dimensions							Accessories							
	Product ^{Note 2}	End effector ^{Note 3}			A	B	C	D	E	F	G	H		I		J		K	
												Size	pcs	Size	pcs	Size	pcs	Size	pcs
KRJV-YAS-31A-CPL54F	3.70	4.59	①	I	2.835	0.315	-	-	-	-	-	M5×10	4	M5×12	4	B type 4×8	1	-	-
KRJV-YAS-31A-CPL70F	6.17	8.82	①	I	3.622	0.315	-	-	-	-	-	M5×10	4	M5×12	4	B type 5×8	1	-	-

● Auto hand changer

Model	Mass (g [oz])		Configuration	Shape	Dimensions							Accessories							
	Product ^{Note 2}	End effector ^{Note 3}			A	B	C	D	E	F	G	H		I		J		K	
												Size	pcs	Size	pcs	Size	pcs	Size	pcs
KRJV-YAS-31A-MJC3	1.41	2.29	①	I	1.654	0.315	-	-	-	-	-	M5×10	4	M3×20	4	B type 2×5	1	-	-
KRJV-YAS-31A-MJC10	2.65	8.29	①	I	2.126	0.394	-	-	-	-	-	M5×12	4	M5×30	4	B type 4×8	1	-	-

● Electric hand

Model	Mass (g [oz])		Configuration	Shape	Dimensions							Accessories							
	Product ^{Note 2}	End effector ^{Note 3}			A	B	C	D	E	F	G	H		I		J		K	
												Size	pcs	Size	pcs	Size	pcs	Size	pcs
KRJV-YAS-31A-EWHA12H	4.59	10.23	①	I	3.150	0.315	-	-	-	-	-	M5×10	4	M3×16	4	B type 2×6	2	-	-
KRJV-YAS-31A-EWHA24H	4.59	12.35	①	I	3.150	0.315	-	-	-	-	-	M5×10	4	M3×16	4	B type 2×6	2	-	-
KRJV-YAS-31A-EWHA36H	4.59	12.70	①	I	3.150	0.315	-	-	-	-	-	M5×10	4	M3×16	4	B type 2×6	2	-	-
KRJV-YAS-31A-EWHA12A	2.47	6.00	①	I	2.283	0.315	-	-	-	-	-	M5×10	4	M3×12	4	B type 2×6	2	-	-
KRJV-YAS-31A-EWHA24A	3.70	9.17	①	I	2.835	0.315	-	-	-	-	-	M5×10	4	M3×12	4	B type 2×6	2	-	-
KRJV-YAS-31A-EWHA36A	3.70	9.17	①	I	2.835	0.315	-	-	-	-	-	M5×10	4	M3×12	4	B type 2×6	2	-	-
KRJV-YAS-31A-EW2H8	2.47	3.17	①	I	2.283	0.315	-	-	-	-	-	M5×10	4	M3×18	4	B type 2×6	2	-	-
KRJV-YAS-31A-EW2H18	3.70	5.64	①	I	2.835	0.315	-	-	-	-	-	M5×10	4	M4×18	4	B type 3×6	2	-	-
KRJV-YAS-31A-EW2HL8	2.47	4.94	①	I	2.283	0.315	-	-	-	-	-	M5×10	4	M3×18	4	B type 2×6	2	-	-
KRJV-YAS-31A-EW2HL18	3.70	8.82	①	I	2.835	0.315	-	-	-	-	-	M5×10	4	M4×18	4	B type 3×6	2	-	-

Note 1: In the drawings, the (★) bolts and pins are accessories.

2: The product weight includes the weight of the bolts and parallel pins that are accessories.

3: The end effectors are not included with these products. They must be ordered separately.

Robot type: Vertically articulated
Mounting face diameter: 31 [1.220]B

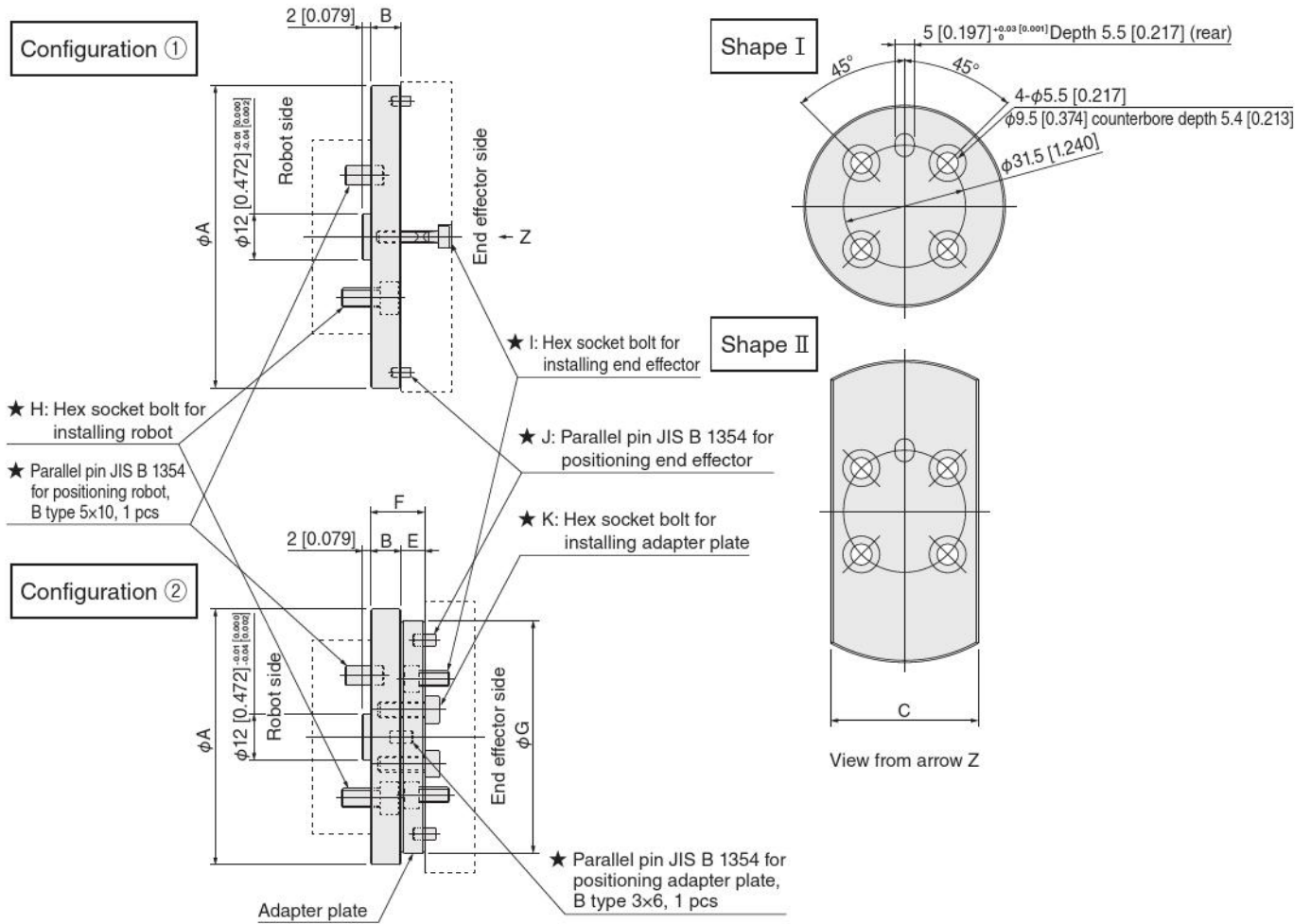

Robot type: Vertically articulated Mounting face diameter: 31 [1.220]B

● Air hand

Model	Mass (g)		Configuration	Shape	Dimensions								Accessories							
	Product ^{Note 2}	End effector ^{Note 3}			A	B	C	D	E	F	G	H		I		J		K		
												Size	pcs	Size	pcs	Size	pcs	Size	pcs	
KRJV-YAS-31B-AFDPG12	140	200	②	I	66	8	-	-	6	14	60	M5×10	4	M4×8	2	B type 3×6	2	M4×12	4	
KRJV-YAS-31B-AFDPG14	170	390	②	I	66	8	-	-	8	16	66	M5×10	4	M5×10	2	B type 3×6	2	M4×14	4	
KRJV-YAS-31B-AFDPGL12	95	330	①	II	96	8	41	-	-	-	-	M5×10	4	M4×20	2	B type 3×6	2	-	-	
KRJV-YAS-31B-AFDPGL14	225	570	②	II	66	8	66	-	8	16	92	M5×10	4	M5×14	2	B type 3×6	2	M4×14	4	
KRJV-YAS-31B-NHE1D20	50	306	①	I	52	8	-	-	-	-	-	M5×10	4	M3×40	3	B type 3×6	1	-	-	
KRJV-YAS-31B-NHE1D25	75	580	①	I	60	8	-	-	-	-	-	M5×10	4	M4×45	3	B type 3×6	1	-	-	

● Compliance light

Model	Mass (g)		Configuration	Shape	Dimensions								Accessories							
	Product ^{Note 2}	End effector ^{Note 3}			A	B	C	D	E	F	G	H		I		J		K		
												Size	pcs	Size	pcs	Size	pcs	Size	pcs	
KRJV-YAS-31B-CPL54F	105	130	①	I	72	8	-	-	-	-	-	M5×10	4	M5×12	4	B type 4×8	1	-	-	
KRJV-YAS-31B-CPL70F	175	250	①	I	92	8	-	-	-	-	-	M5×10	4	M5×12	4	B type 5×8	1	-	-	

● Auto hand changer

Model	Mass (g)		Configuration	Shape	Dimensions								Accessories							
	Product ^{Note 2}	End effector ^{Note 3}			A	B	C	D	E	F	G	H		I		J		K		
												Size	pcs	Size	pcs	Size	pcs	Size	pcs	
KRJV-YAS-31B-MJC3	40	65	①	I	42	8	-	-	-	-	-	M5×10	4	M3×20	4	B type 2×5	1	-	-	
KRJV-YAS-31B-MJC10	75	235	①	I	54	10	-	-	-	-	-	M5×12	4	M5×30	4	B type 4×8	1	-	-	

● Electric hand

Model	Mass (g)		Configuration	Shape	Dimensions								Accessories							
	Product ^{Note 2}	End effector ^{Note 3}			A	B	C	D	E	F	G	H		I		J		K		
												Size	pcs	Size	pcs	Size	pcs	Size	pcs	
KRJV-YAS-31B-EWHA12H	125	290	①	I	80	8	-	-	-	-	-	M5×10	4	M3×16	4	B type 2×6	2	-	-	
KRJV-YAS-31B-EWHA24H	125	350	①	I	80	8	-	-	-	-	-	M5×10	4	M3×16	4	B type 2×6	2	-	-	
KRJV-YAS-31B-EWHA36H	125	360	①	I	80	8	-	-	-	-	-	M5×10	4	M3×16	4	B type 2×6	2	-	-	
KRJV-YAS-31B-EWHA12A	70	170	①	I	58	8	-	-	-	-	-	M5×10	4	M3×12	4	B type 2×6	2	-	-	
KRJV-YAS-31B-EWHA24A	105	260	①	I	72	8	-	-	-	-	-	M5×10	4	M3×12	4	B type 2×6	2	-	-	
KRJV-YAS-31B-EWHA36A	105	260	①	I	72	8	-	-	-	-	-	M5×10	4	M3×12	4	B type 2×6	2	-	-	
KRJV-YAS-31B-EW2H8	70	90	①	I	58	8	-	-	-	-	-	M5×10	4	M3×18	4	B type 2×6	2	-	-	
KRJV-YAS-31B-EW2H18	105	160	①	I	72	8	-	-	-	-	-	M5×10	4	M4×18	4	B type 3×6	2	-	-	
KRJV-YAS-31B-EW2HL8	70	140	①	I	58	8	-	-	-	-	-	M5×10	4	M3×18	4	B type 2×6	2	-	-	
KRJV-YAS-31B-EW2HL18	105	250	①	I	72	8	-	-	-	-	-	M5×10	4	M4×18	4	B type 3×6	2	-	-	

Note 1: In the drawings, the (★) bolts and pins are accessories.

2: The product weight includes the weight of the bolts and parallel pins that are accessories.

3: The end effectors are not included with these products. They must be ordered separately.

Robot type: Vertically articulated Mounting face diameter: 31 [1.220]B

● Air hand

Model	Mass (g [oz])		Configuration	Shape	Dimensions							Accessories							
	Product ^{Note 2}	End effector ^{Note 3}			A	B	C	D	E	F	G	H		I		J		K	
												Size	pcs	Size	pcs	Size	pcs	Size	pcs
KRJV-YAS-31B-AFDPG12	4.94	7.05	②	I	2.598	0.315	-	-	0.236	0.551	2.362	M5×10	4	M4×8	2	B type 3×6	2	M4×12	4
KRJV-YAS-31B-AFDPG14	6.00	13.76	②	I	2.598	0.315	-	-	0.315	0.630	2.598	M5×10	4	M5×10	2	B type 3×6	2	M4×14	4
KRJV-YAS-31B-AFDPL12	3.35	11.64	①	II	3.780	0.315	1.614	-	-	-	-	M5×10	4	M4×20	2	B type 3×6	2	-	-
KRJV-YAS-31B-AFDPL14	7.94	20.11	②	II	2.598	0.315	2.598	-	0.315	0.630	3.622	M5×10	4	M5×14	2	B type 3×6	2	M4×14	4
KRJV-YAS-31B-NHE1D20	1.76	10.79	①	I	2.047	0.315	-	-	-	-	-	M5×10	4	M3×40	3	B type 3×6	1	-	-
KRJV-YAS-31B-NHE1D25	2.65	20.46	①	I	2.362	0.315	-	-	-	-	-	M5×10	4	M4×45	3	B type 3×6	1	-	-

● Compliance light

Model	Mass (g [oz])		Configuration	Shape	Dimensions							Accessories							
	Product ^{Note 2}	End effector ^{Note 3}			A	B	C	D	E	F	G	H		I		J		K	
												Size	pcs	Size	pcs	Size	pcs	Size	pcs
KRJV-YAS-31B-CPL54F	3.70	4.59	①	I	2.835	0.315	-	-	-	-	-	M5×10	4	M5×12	4	B type 4×8	1	-	-
KRJV-YAS-31B-CPL70F	6.17	8.82	①	I	3.622	0.315	-	-	-	-	-	M5×10	4	M5×12	4	B type 5×8	1	-	-

● Auto hand changer

Model	Mass (g [oz])		Configuration	Shape	Dimensions							Accessories							
	Product ^{Note 2}	End effector ^{Note 3}			A	B	C	D	E	F	G	H		I		J		K	
												Size	pcs	Size	pcs	Size	pcs	Size	pcs
KRJV-YAS-31B-MJC3	1.41	2.29	①	I	1.654	0.315	-	-	-	-	-	M5×10	4	M3×20	4	B type 2×5	1	-	-
KRJV-YAS-31B-MJC10	2.65	8.29	①	I	2.126	0.394	-	-	-	-	-	M5×12	4	M5×30	4	B type 4×8	1	-	-

● Electric hand

Model	Mass (g [oz])		Configuration	Shape	Dimensions							Accessories							
	Product ^{Note 2}	End effector ^{Note 3}			A	B	C	D	E	F	G	H		I		J		K	
												Size	pcs	Size	pcs	Size	pcs	Size	pcs
KRJV-YAS-31B-EWHA12H	4.41	10.23	①	I	3.150	0.315	-	-	-	-	-	M5×10	4	M3×16	4	B type 2×6	2	-	-
KRJV-YAS-31B-EWHA24H	4.41	12.35	①	I	3.150	0.315	-	-	-	-	-	M5×10	4	M3×16	4	B type 2×6	2	-	-
KRJV-YAS-31B-EWHA36H	4.41	12.70	①	I	3.150	0.315	-	-	-	-	-	M5×10	4	M3×16	4	B type 2×6	2	-	-
KRJV-YAS-31B-EWHA12A	2.47	6.00	①	I	2.283	0.315	-	-	-	-	-	M5×10	4	M3×12	4	B type 2×6	2	-	-
KRJV-YAS-31B-EWHA24A	3.70	9.17	①	I	2.835	0.315	-	-	-	-	-	M5×10	4	M3×12	4	B type 2×6	2	-	-
KRJV-YAS-31B-EWHA36A	3.70	9.17	①	I	2.835	0.315	-	-	-	-	-	M5×10	4	M3×12	4	B type 2×6	2	-	-
KRJV-YAS-31B-EW2H8	2.47	3.17	①	I	2.283	0.315	-	-	-	-	-	M5×10	4	M3×18	4	B type 2×6	2	-	-
KRJV-YAS-31B-EW2H18	3.70	5.64	①	I	2.835	0.315	-	-	-	-	-	M5×10	4	M4×18	4	B type 3×6	2	-	-
KRJV-YAS-31B-EW2HL8	2.47	4.94	①	I	2.283	0.315	-	-	-	-	-	M5×10	4	M3×18	4	B type 2×6	2	-	-
KRJV-YAS-31B-EW2HL18	3.70	8.82	①	I	2.835	0.315	-	-	-	-	-	M5×10	4	M4×18	4	B type 3×6	2	-	-

Note 1: In the drawings, the (★) bolts and pins are accessories.

2: The product weight includes the weight of the bolts and parallel pins that are accessories.

3: The end effectors are not included with these products. They must be ordered separately.

Robot type: Vertically articulated
Mounting face diameter: 56 [2.205]

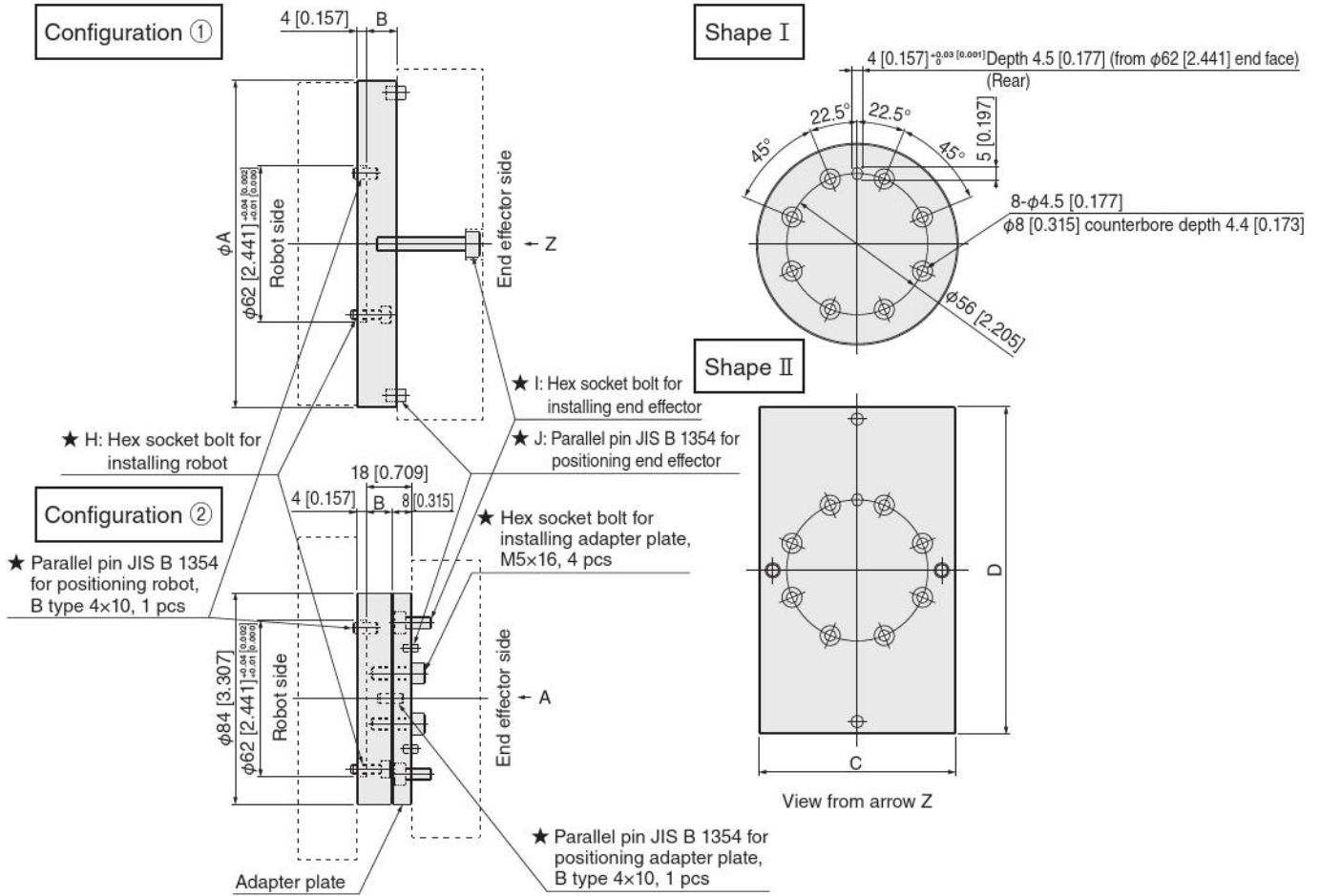

Robot type: Vertically articulated
Mounting face diameter: 56 [2.205]

● Air hand

Model	Mass (g)		Configuration	Shape	Dimensions				Accessories					
	Product ^{Note 2}	End effector ^{Note 3}			A	B	C	D	H		I		J	
									Size	pcs	Size	pcs	Size	pcs
KRJV-YAS-56-AFDPG18	340	690	②	I	84	10	-	-	M4×12	8	M5×10	2	B type 3×6	2
KRJV-YAS-56-AFDPG25	435	1520	①	II	-	12	78	130	M4×12	8	M6×35	2	B type 5×8	2
KRJV-YAS-56-AFDPGL18	340	1020	②	I	84	10	-	-	M4×12	8	M5×10	2	B type 3×6	2
KRJV-YAS-56-AFDPGL25	795	2320	①	II	-	12	78	210	M4×12	8	M6×35	2	B type 5×8	2
KRJV-YAS-56-NHE1D25	130	580	①	I	70	10	-	-	M4×12	6	M4×45	3	B type 3×6	1

● Compliance light

Model	Mass (g)		Configuration	Shape	Dimensions				Accessories					
	Product ^{Note 2}	End effector ^{Note 3}			A	B	C	D	H		I		J	
									Size	pcs	Size	pcs	Size	pcs
KRJV-YAS-56-CPL90F	420	460	①	I	116	10	-	-	M4×12	8	M6×16	4	B type 6×12	1

● Auto hand changer

Model	Mass (g)		Configuration	Shape	Dimensions				Accessories					
	Product ^{Note 2}	End effector ^{Note 3}			A	B	C	D	H		I		J	
									Size	pcs	Size	pcs	Size	pcs
KRJV-YAS-56-MJC20	135	470	①	I	70	14	-	-	M4×12	8	M5×35	4	B type 5×8	1

● Electric hand

Model	Mass (g)		Configuration	Shape	Dimensions				Accessories					
	Product ^{Note 2}	End effector ^{Note 3}			A	B	C	D	H		I		J	
									Size	pcs	Size	pcs	Size	pcs
KRJV-YAS-56-EWHA24H	180	350	①	I	80	10	-	-	M4×12	8	M3×16	4	B type 2×6	2
KRJV-YAS-56-EWHA36H	180	360	①	I	80	10	-	-	M4×12	8	M3×16	4	B type 2×6	2
KRJV-YAS-56-EWHA24A	140	260	①	I	72	10	-	-	M4×12	8	M3×12	4	B type 2×6	2
KRJV-YAS-56-EWHA36A	140	260	①	I	72	10	-	-	M4×12	8	M3×12	4	B type 2×6	2
KRJV-YAS-56-EW2H28	215	360	①	I	86	10	-	-	M4×12	8	M4×25	4	B type 3×6	2
KRJV-YAS-56-EW2HL28	215	480	①	I	86	10	-	-	M4×12	8	M4×25	4	B type 3×6	2

Note 1: In the drawings, the (★) bolts and pins are accessories.
 2: The product weight includes the weight of the bolts and parallel pins that are accessories.
 3: The end effectors are not included with these products. They must be ordered separately.

Robot type: Vertically articulated

Mounting face diameter: 56 [2.205]

● Air hand

Model	Mass (g [oz])		Configuration	Shape	Dimensions				Accessories					
	Product ^{Note 2}	End effector ^{Note 3}			A	B	C	D	H		I		J	
									Size	pcs	Size	pcs	Size	pcs
KRJV-YAS-56-AFDPG18	11.99	24.34	②	I	3.307	0.394	-	-	M4×12	8	M5×10	2	B type 3×6	2
KRJV-YAS-56-AFDPG25	15.34	53.62	①	II	-	0.472	3.071	5.118	M4×12	8	M6×35	2	B type 5×8	2
KRJV-YAS-56-AFDPGL18	11.99	35.98	②	I	3.307	0.394	-	-	M4×12	8	M5×10	2	B type 3×6	2
KRJV-YAS-56-AFDPGL25	28.04	81.83	①	II	-	0.472	3.071	8.268	M4×12	8	M6×35	2	B type 5×8	2
KRJV-YAS-56-NHE1D25	4.59	20.46	①	I	2.756	0.394	-	-	M4×12	6	M4×45	3	B type 3×6	1

● Compliance light

Model	Mass (g [oz])		Configuration	Shape	Dimensions				Accessories					
	Product ^{Note 2}	End effector ^{Note 3}			A	B	C	D	H		I		J	
									Size	pcs	Size	pcs	Size	pcs
KRJV-YAS-56-CPL90F	14.81	16.23	①	I	4.567	0.394	-	-	M4×12	8	M6×16	4	B type 6×12	1

● Auto hand changer

Model	Mass (g [oz])		Configuration	Shape	Dimensions				Accessories					
	Product ^{Note 2}	End effector ^{Note 3}			A	B	C	D	H		I		J	
									Size	pcs	Size	pcs	Size	pcs
KRJV-YAS-56-MJC20	4.76	16.58	①	I	2.756	0.551	-	-	M4×12	8	M5×35	4	B type 5×8	1

● Electric hand

Model	Mass (g [oz])		Configuration	Shape	Dimensions				Accessories					
	Product ^{Note 2}	End effector ^{Note 3}			A	B	C	D	H		I		J	
									Size	pcs	Size	pcs	Size	pcs
KRJV-YAS-56-EWHA24H	6.35	12.35	①	I	3.150	0.394	-	-	M4×12	8	M3×16	4	B type 2×6	2
KRJV-YAS-56-EWHA36H	6.35	12.70	①	I	3.150	0.394	-	-	M4×12	8	M3×16	4	B type 2×6	2
KRJV-YAS-56-EWHA24A	4.94	9.17	①	I	2.835	0.394	-	-	M4×12	8	M3×12	4	B type 2×6	2
KRJV-YAS-56-EWHA36A	4.94	9.17	①	I	2.835	0.394	-	-	M4×12	8	M3×12	4	B type 2×6	2
KRJV-YAS-56-EW2H28	7.58	12.70	①	I	3.386	0.394	-	-	M4×12	8	M4×25	4	B type 3×6	2
KRJV-YAS-56-EW2HL28	7.58	16.93	①	I	3.386	0.394	-	-	M4×12	8	M4×25	4	B type 3×6	2

Note 1: In the drawings, the (★) bolts and pins are accessories.

2: The product weight includes the weight of the bolts and parallel pins that are accessories.

3: The end effectors are not included with these products. They must be ordered separately.

Robot type: Vertically articulated
Mounting face diameter: 80 [3.150]

● **Model: KRJV-YAS-80-MJC60**

Product mass 70 g [2.47 oz]

End effector mass: 1000 g [35.27 oz]

Since it can be mounted directly to the robot, only the following 2 parts are required.

- Hex socket bolt, M8×30, 4 pcs
- Parallel pin, B type 8×12, 1 pcs

● **Model: KRJV-YAS-80-MJC100**

Product mass 560 g [19.75 oz]

End effector mass: 1800 g [63.49 oz]

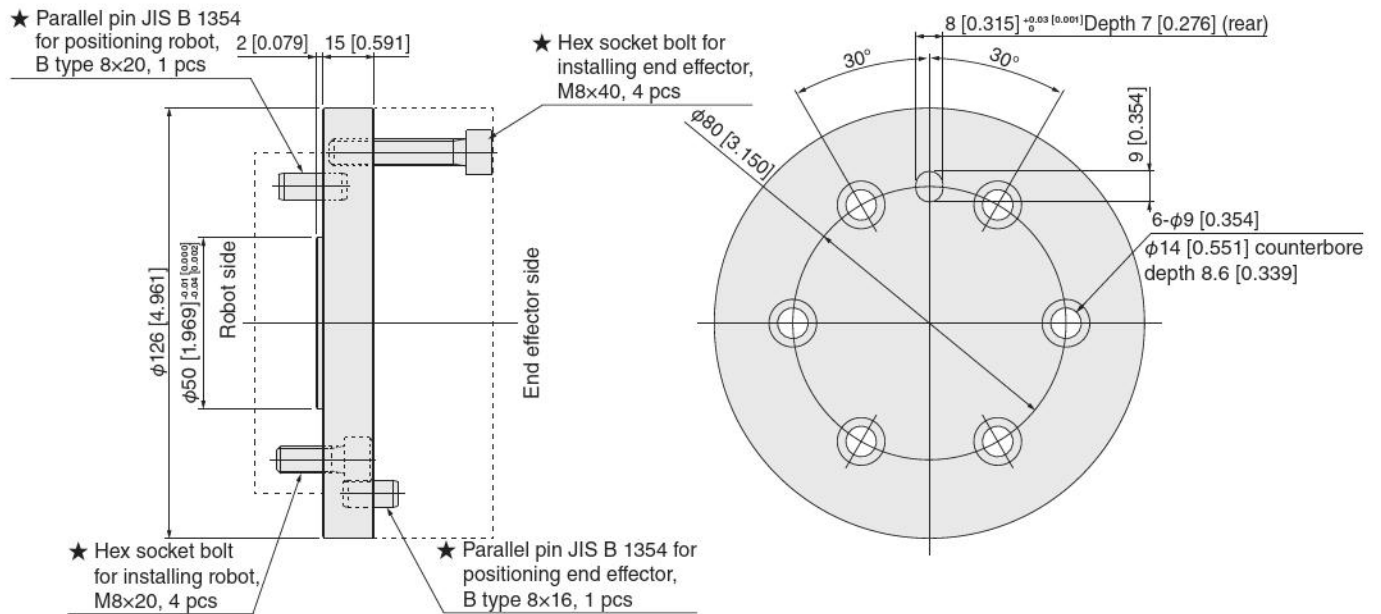

- Note 1: In the drawings, the (★) bolts and pins are accessories.
 2: The product weight includes the weight of the bolts and parallel pins that are accessories.
 3: The end effectors are not included with these products. They must be ordered separately.

Robot type: Vertically articulated
Mounting face diameter: 125 [4.921]A/125 [4.921]B

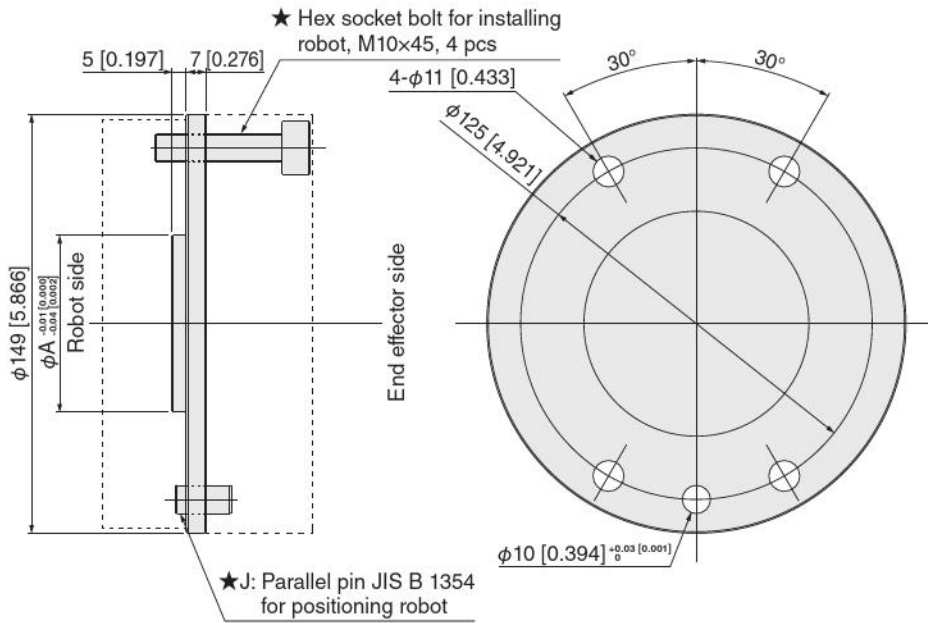

● Auto hand changer

Model	Mass (g [oz])		Dimensions	Accessories	
	Product ^{Note 2}	End effector ^{Note 3}		J	
			Size	pcs	
KRJV-YAS-125A-MJC150	380 [13.40]	2700 [95.24]	63 [2.480]	B type 10×20	1
KRJV-YAS-125B-MJC150	345 [12.17]	2700 [95.24]	31.5 [1.240]	B type 10×30	1

Note 1: In the drawings, the (★) bolts and pins are accessories.
 2: The product weight includes the weight of the bolts and parallel pins that are accessories.
 3: The end effectors are not included with these products. They must be ordered separately.

Limited Warranty

KOGANEI CORP. warrants its products to be free from defects in material and workmanship subject to the following provisions.

Warranty Period The warranty period is 180 days from the date of delivery.

Koganei Responsibility If a defect in material or workmanship is found during the warranty period, KOGANEI CORP. will replace any part proved defective under normal use free of charge and will provide the service necessary to replace such a part.

Limitations

- This warranty is in lieu of all other warranties, expressed or implied, and is limited to the original cost of the product and shall not include any transportation fee, the cost of installation or any liability for direct, indirect or consequential damage or delay resulting from the defects.

- KOGANEI CORP. shall in no way be liable or responsible for injuries or damage to persons or property arising out of the use or operation of the manufacturer's product.

- This warranty shall be void if the engineered safety devices are removed, made inoperative or not periodically checked for proper functioning.

- Any operation beyond the rated capacity, any improper use or application, or any improper installation of the product, or any substitution upon it with parts not furnished or approved by KOGANEI CORP., shall void this warranty.

- This warranty covers only such items supplied by KOGANEI CORP. The products of other manufacturers are covered only by such warranties made by those original manufacturers, even though such items may have been included as the components.

The specifications are subject to change without notice.

URL <http://www.koganei.co.jp>

E-mail: overseas@koganei.co.jp



KOGANEI CORPORATION

OVERSEAS DEPARTMENT

Takanawa Office, 3F, PMO Takanawa Gateway, 2-19-17, Takanawa, Minato-Ku, Tokyo, 108-0074, Japan
Tel: (+81)-3-6721-7478 Fax: (+81)-3-5424-1021

KOGANEI INTERNATIONAL AMERICA, INC.

48860 Milmont Drive, suite 108C, Fremont, California 94538
Tel: 1-510-744-1626 Fax: 1-510-744-1676

SHANGHAI KOGANEI INTERNATIONAL TRADING CORPORATION

RM2601-2602, Tongda Venture Building No.1, Lane 600, Tianshan Road, Shanghai, China (200051)
Tel: 86-21-6145-7313 Fax: 86-21-6145-7323

TAIWAN KOGANEI TRADING CO.,LTD

Rm. 2, 16F., No88, Sec. 2, Zhongxiao E. Rd., Zhongzheng Dist., Taipei City 100, Taiwan(ROC)
Tel: 886-2-2393-2717 Fax: 886-2-2393-2719

KOGANEI KOREA CO.,LTD

A-3001, Heungdeok IT Valley Bldg., Heungkeok 1-ro, 13, Giheung-gu, Yongin-si, Gyeonggi-do, 446-908, KOREA
Tel: 82-31-246-0414 Fax: 82-31-246-0415

KOGANEI (THAILAND) CO.,LTD

555, Rasa One Building A, 11th Fl., Unit 1107 and 1108, Phaholyothin Road, Chatuchak, Chatuchak, Bangkok 10900
Tel: +66 (0) 2513-1228-31 Fax: +66 (0) 2513-1232

KOGANEI AUTOMATION (MALAYSIA) SDN, BHD.

Suite 29-2, Level 29, Menara 1MK, No.1, Jalan Kiara, Mont Kiara 50480, Kuala Lumpur, Malaysia
Tel: 60-12-537-7086

KOGANEI ASIA PTE. LTD.

69 Ubi Road 1, #05-18 Oxley Bizhub Singapore 408731
Tel: 65-6293-4512 Fax: 65-6293-4513